

# GERMAN HEALTH BATHROOM

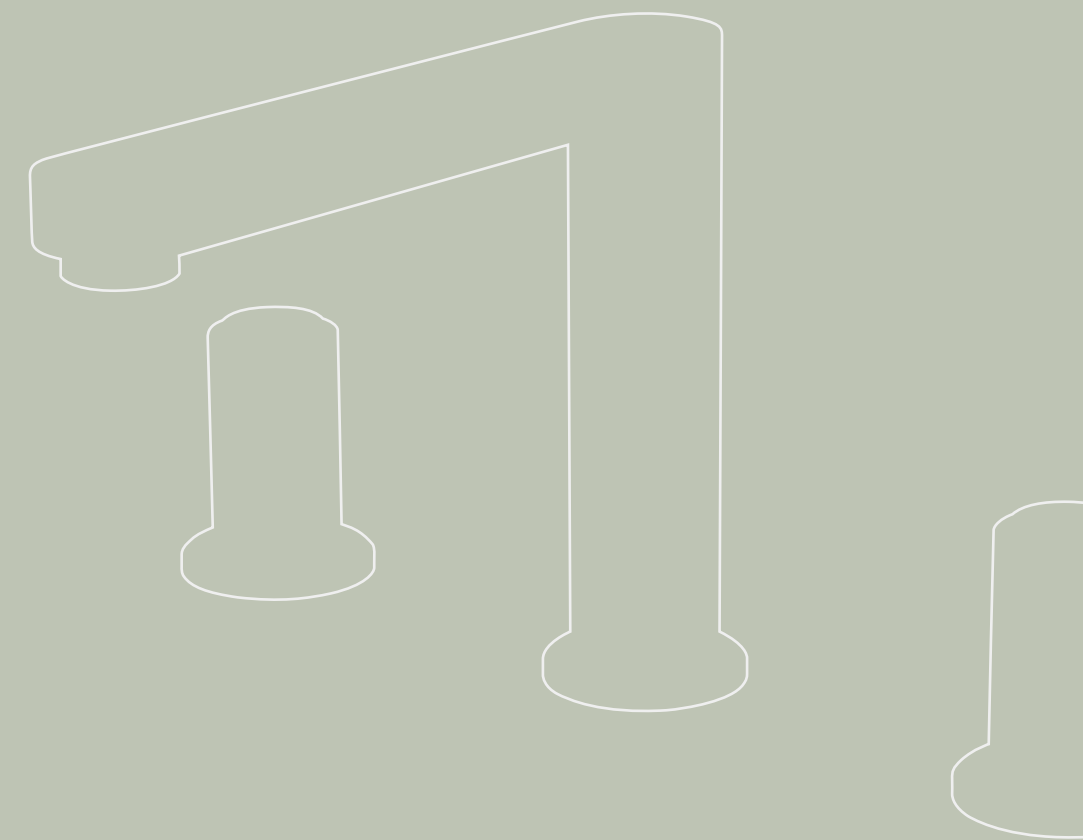

德国总部 COSO Technologie Deutschland GmbH  
Am Wasserfall 1 DE-51570 Windeck-schladem Germany  
+49(0)5118973-798  
[www.coso-global.com](http://www.coso-global.com)

德国 COSO 科技公司  
中国·COSO 高斯·营销管理中心  
佛山市顺德区杏坛镇德进路 3 号  
400-882-1238  
[www.coso.cn](http://www.coso.cn)

COSO®

COSO®



**GERMAN**

health

bathroom



COSO takes the German industrial standards as the design theory, producing the most logical and beautiful products by high quality material, ergonomics, mathematical space, rigorous manufacturing and rational beauty.



---

# PRECISION WORK MODEL

Create more attractive beauty of precision work with high quality standards.

---

COSO adopts the high quality materials to produce the products. COSO never miss any small production processes thereby creating ultra-high quality products. Focusing on the advanced design of combination of structure and spirit, shining in every COSO products.

COSO has mental discernment, creating a high quality life successfully. Refusing to imitate, being originality, every product of COSO is different and unique, so naturally becomes the focus of the public.

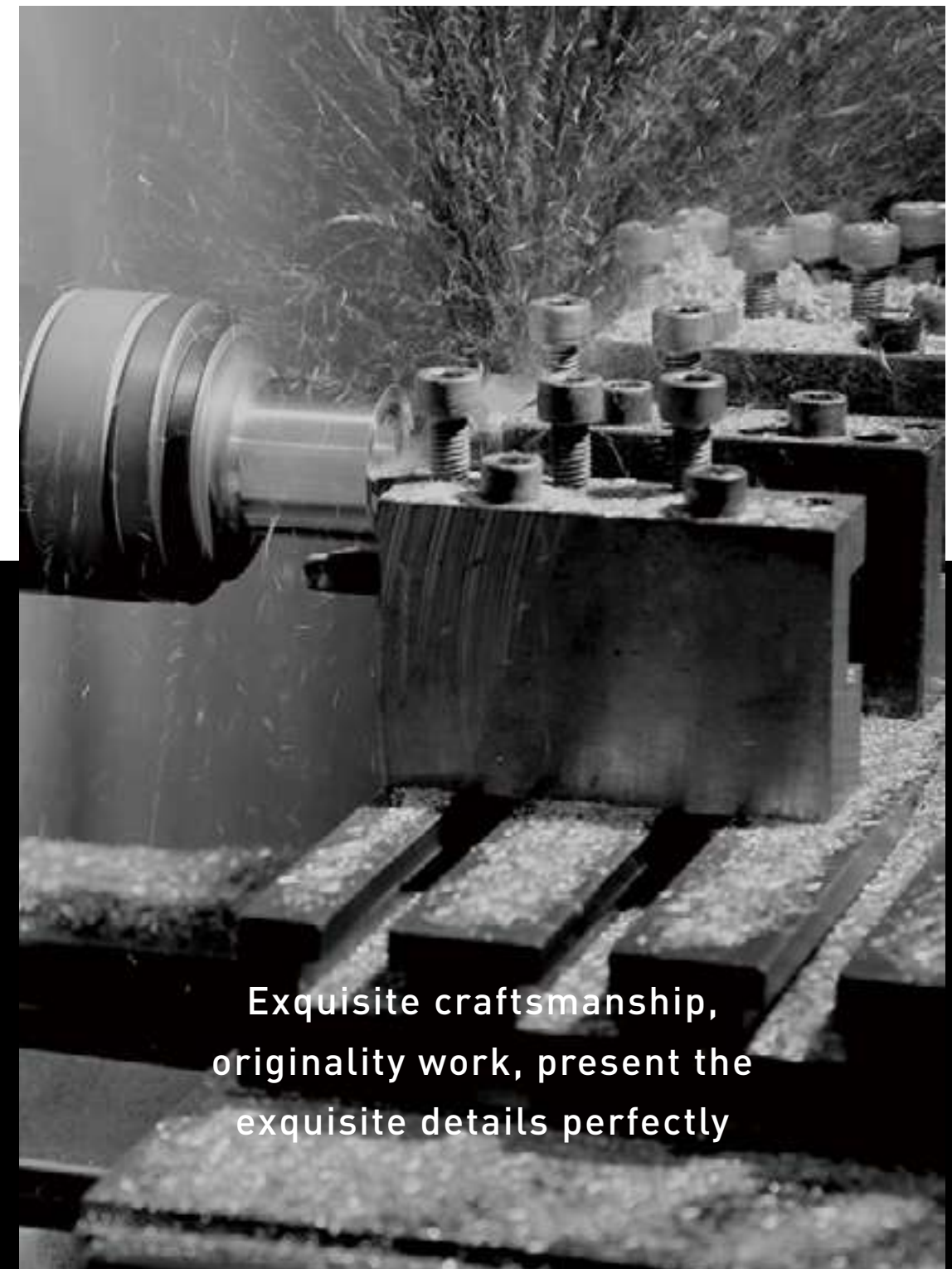

**Exquisite craftsmanship,  
originality work, present the  
exquisite details perfectly**



**C**  
Chrome  
经典铬



**M**  
Elegant black  
雅黑



**G**  
Zirconium Gold  
皓金



**E**  
Brown bronze  
棕古铜



**J**  
Bronze  
青古铜



**Q**  
Gun gray  
枪灰



**A**  
Flange gold  
法兰金



**MC**  
Elegant black + Chrome  
黑 + 铬



**MG**  
Elegant Black + Zirconium Gold  
黑 + 金



**CG**  
Chrome + Zirconium Gold  
铬 + 金



# COSO GERMAN INDUSTRIAL

COSO TAKES THE GERMAN INDUSTRIAL STANDARDS AS THE DESIGN THEORY, PRODUCING THE MOST LOGICAL AND BEAUTIFUL PRODUCTS BY HIGH QUALITY MATERIAL, ERGONOMICS, MATHEMATICAL SPACE, RIGOROUS MANUFACTURING AND RATIONAL BEAUTY.

**BECOME THE SYNONYM OF  
HEALTH, PRACTICABILITY,  
RATIONALITY AND SUBSTANTIAL.**

# PRODUCT

## NAVIGATION



# CONTENT

GLAM SERIES 迷音系列	_011	EXPOSED SHOWER SYSTEM 明装淋浴花洒系统	_147
VERVE SERIES 神韵系列	_037	CONCEALED SHOWER SYSTEM 暗装淋浴花洒系统	_153
OPEL SERIES 欧宝系列	_053	CUSTOMIZATION SYSTEM 定制系统	_163
PROSPEROUS TANG SERIES 大唐盛世系列	_069	KITCHEN SYSTEM 厨房系统	_189
BAMBOO SERIES 梅雨竹林系列	_085	HARDWARE SYSTEM 五金系统	_203
NOAH SERIES 诺亚方舟系列	_095	TOILET SERIES 坐便器系列	_219
WEAVER SERIES 唯沃系列	_105	BASIN SERIES 台盆系列	_247
LANE SERIES 水浴风尚系列	_115	BATHTUB SERIES 浴缸系列	_257
MIG SERIES 米格系列	_127	ENGINEERING SYSTEM 工程系统	_283
LIVABLE SERIES 宜居系列	_135		



---

# GLAM SERIES

迷音系列

---

THE DELICATE CRAFT OF THE BUZZER HANDLE MOVES UP  
AND DOWN, LIKE A DJ'S MIXER, MAKE EVERY CONTACT WITH  
YOU EXCITING AND WONDERFUL.

# HOMMIZATION



THE BATHROOM THAT  
AWAKENS OUR SENSES.



# ELEGANCE



EXTREME BEAUTY AND  
ELEGANCE, COMBINATION  
OF INTELLIGENCE AND  
PERFECTION, DEPTH AND  
NOBILITY.





# ROMANTIC

ROMANTIC AND WISDOM



**ELEGANT IN LOOK,  
AND WISE IN HEART.**

# METICULOUS DESIGN

AND METICULOUS DESIGN, THE INSIDE MEANING IS NO LONGER DEEP,  
WITH THE OUTSTANDING SELFHOOD FULLY EXPRESSED.



CALMNESS IS THE ONLY VERVE OF LIFE, LIVING OUTSTANDINGLY, LIVING WITH ELEGANT RHYTHMS, RESPLENDENT CLEAN STREAM FLOWS AT HOME .



# ELEGANCE





In the romantic world, it is wisdom that gives me power and courage, to lightly uncover the fog. whether is brilliant or not, i never complain, only because i am to kee this reserved and pure heart.



## ROMANTIC AND WISDOM





# NIMBLE



There is a kind of beauty,  
Always bursting in the unconscious  
touch, Space reaching such  
realm is also superb,  
This is textural experience,  
in only a moment, Kind of  
textures, kind of unique life!







AA6011  
AQ6011

Single lever basin faucet  
Spout Reach:  
(L)140mm / (H)125mm

单孔台下盆龙头  
出水嘴距离: 140×125mm



BA6012  
BQ6012

Single lever basin faucet tall  
Spout Reach:  
(L)165mm / (H)235mm

单孔台上盆龙头  
出水嘴距离: 165×235mm



PA6013  
PQ6013

3-hole basin faucet  
Spout Reach:  
(L)165mm / (H)133mm

三孔面盆龙头  
出水嘴距离: 165×133mm



FQ6016

Basin faucet wall mounted  
Spout Reach: 183mm

暗装面盆龙头  
出水嘴距离: 183mm



NQ6019

4-hole bathtub combination  
Spout Reach:  
(L)205mm / (H)134mm

缸边浴缸龙头  
出水嘴距离: 205×134mm



iQ6014

Bathtub faucet wall mounted  
Spout Reach: 190mm

暗装浴缸龙头  
出水嘴距离: 190mm



KA6018  
KQ6018

Basin faucet floor-standing  
Spout Reach:  
(L)200mm / (H)806mm

落地浴缸龙头  
出水嘴距离: 200×806mm



KA6018S  
KQ6018S

Bathtub faucet floor-standing  
Spout Reach:  
(L)200mm / (H)1006mm

落地面盆龙头  
出水嘴距离: 200×1006mm



LQ6017/101/8952

Perfect shower set with Thermostatic  
Head shower size: Ø250mm

暗装淋浴花洒套装 (恒温)  
顶喷尺寸: Ø250mm



LA6017S/101/8952  
LQ6017S/101/8952

Perfect shower set with Thermostatic  
Head shower size: Ø250mm

暗装淋浴花洒套装 (恒温)  
顶喷尺寸: Ø250mm



LQ6010/107/9201

Perfect shower set with Thermostatic  
Head shower size: 250×250mm

暗装淋浴花洒套装 (恒温)  
顶喷尺寸: 250×250mm



CA6015/101/8952  
CQ6015/101/8952

Thermostatic revealed shower set  
Head shower size: Ø250mm

明装淋浴花洒套装 (恒温)  
顶喷尺寸: Ø250mm



GLAM Series 迷音系列



WA5901

WQ5901

Robe hook  
Size:45×52×62mm

单衣钩  
尺寸: 45×52×62mm



WA5823

WQ5823

Toilet Tissue Holder  
Size:190×93×122mm

纸巾架  
尺寸: 190×93×122mm



WA5908

WQ5908

Toilet Brush  
Size:110×164×385mm

卫生刷  
尺寸: 110×164×385mm



WA5909

WQ5909

Towel Bar  
Size:645×62×45mm

单杆毛巾架  
尺寸: 645×62×45mm



WA5911

WQ5911

Towel Shelf  
Size:645×198×105mm

多杆浴巾架  
尺寸: 645×198×105mm



---

# VERVE SERIES

神韵系列

---

A DANCE OF SQUARES AND CIRCLES SWIRLED AROUND THE BATHROOM, THE CHARM SERIES OF THE JADE MAKES THE WATER HAVE A GENTLE PERSONALITY. SUCH A HOT BATH IS THE PERFECT CARE.





Explanation of modern simplicity. Enjoy bath tenderness and quality life.

# MODERN SIMPLICITY



Implicative luster and various lines lead to sound effect under whatsoever arrangement.

# AESTHETICS









A good design is the perfect combination of the appearance and function, and it will help to create a harmonious life.





**AC6051**  
Single lever basin faucet  
Spout Reach:  
(L)150mm / (H)118mm  
单孔台下盆龙头  
出水嘴距离: 150×118mm



**BC6052**  
Single lever basin faucet tall  
Spout Reach:  
(L)205mm / (H)228mm  
单孔台上盆龙头  
出水嘴距离: 205×228mm



**PC6053**  
3-hole basin faucet  
Spout Reach:  
(L)150mm / (H)133mm  
三孔面盆龙头  
出水嘴距离: 150×133mm



**FC6056S**  
Basin faucet wall mounted  
Spout Reach: 208mm  
暗装面盆龙头  
出水嘴距离: 208mm



**iC6050/3707/9001**  
Shower set  
简易淋浴花洒



**iC6050S/3719/9001**  
Shower set  
简易淋浴花洒



**FC6056**  
Basin faucet wall mounted  
Spout Reach: 208mm  
暗装面盆龙头  
出水嘴距离: 208mm



**NC6059**  
4-hole bathtub combination  
Spout Reach:  
(L)205mm / (H)133mm  
缸边浴缸龙头  
出水嘴距离: 205×133mm



**KC6058**  
Floor-standing bathtub faucet  
Spout Reach:  
(L)200mm / (H)806mm  
落地浴缸龙头  
出水嘴距离: 200×806mm



**KC6058S**  
Floor-standing washbasin faucet  
Spout Reach:  
(L)205mm / (H)993mm  
落地面盆龙头  
出水嘴距离: 205×993mm



**LC6060/1003/9001**  
Perfect shower set with 2-functions  
Head shower size: 300×190mm  
暗装淋浴花洒套装 (恒温)  
顶喷尺寸: 300×190mm



**LC6061/1003/9001**  
Perfect shower set with 2-functions  
Head shower size: 300×190mm  
暗装淋浴花洒套装  
顶喷尺寸: 300×190mm



**LC6057/1003/9001**  
Perfect shower set with 3- functions  
Head shower size: 300×190mm  
暗装淋浴花洒套装  
顶喷尺寸: 300×190mm



**CC6055/1003/9001**  
Revealed shower set  
Head shower size: 300×190mm  
明装淋浴花洒套装  
顶喷尺寸: 300×190mm



Explanation of modern simplicity. Enjoy bath tenderness and quality life.

IVERVE Series 神韵系列



WC5331

Robe hook  
Size: 20×40×58mm

单衣钩  
尺寸: 20×40×58mm



WC5333

Toilet Tissue Holder  
Size: 175×60×30mm

纸巾架  
尺寸: 175×60×30mm



WC5335

Double Toilet Tissue Holder  
Size: 300×60×30mm

双纸巾架  
尺寸: 300×60×30mm



WC5336

Toilet Brush  
Size: 80×102×376mm

卫生刷  
尺寸: 80×102×376mm



WC5337

Towel Bar  
Size: 600×60×20mm

单杆毛巾架  
尺寸: 600×60×20mm



WC5338

Towel Shelf  
Size: 600×208×20mm

多杆浴巾架  
尺寸: 600×208×20mm



---

# OPEL SERIES

欧宝系列

---

CHILLED IN THE GENTLE, EMITTING A METALLIC LUSTER,  
EUROPEAN-STYLE INTERNATIONAL GRADE DESIGN EXUDES  
RATIONAL AND MODERN ATMOSPHERE, TIME SEEMS TO  
PRECIPITATE AT THIS MOMENT.





ARTISTIC CLASSIC TOUCHES THE DEPTHS OF THE SOUL.  
GORGEOUS AND UNIQUE DESIGN AND SUPERB  
CRAFTSMANSHIP MAXIMISE ITS BEAUTY AND TOUCHED YOUR HEART,  
COMBINATION OF CREATIVITY AND TECHNOLOGY.

# ARTISTIC CLASSIC





FOR NEARLY A CENTURY, WE'VE BEEN IMPROVING THE WATER EXPERIENCE AND MAKING WATER SMART.



Perceive your needs, give you the touch and temperature you want, let the water become beautiful enjoyment, not only pleasing to the eye, but also pleasing to the heart, give you more intimate care.

# WISDOM





# ATMOSPHERE SEDATE



EUROPEAN STYLE IS COLORFUL AND ROMANTIC, CAN BUILD A DELICATE FEELING AND QUALITY FEELING EASILY.







GORGEOUS

IT IS EXQUISITE  
AND ELEGANT



**818010106**  
Single lever basin faucet  
Spout Reach:  
[L]116mm / [H]112mm  
单孔台下盆龙头  
出水嘴距离: 116×112mm



**818010206**  
Single lever basin faucet tall  
Spout Reach:  
[L]150mm / [H]214mm  
单孔台上盆龙头  
出水嘴距离: 150×214mm



**818050206**  
Basin faucet wall mounted  
Spout Reach: 198mm  
暗装面盆龙头  
出水嘴距离: 198mm



**818020106**  
3-hole basin faucet  
Spout Reach:  
[L]143mm / [H]188mm  
三孔面盆龙头  
出水嘴距离: 143×188mm



**818070106**  
Revealed shower set  
Head shower size: Ø225mm  
明装淋浴花洒套装  
顶喷花洒尺寸: Ø225mm



**818150106**  
Concealed shower set  
Head shower size: Ø225mm  
暗装淋浴花洒套装  
顶喷花洒尺寸: Ø225mm



**818150306**  
Perfect shower set with Thermostatic  
Head shower size: Ø225mm  
暗装淋浴花洒套装 (恒温)  
顶喷花洒尺寸: Ø225mm



**818120106**  
5-hole bathtub combination  
Spout Reach:  
[L]143mm / [H]188mm  
缸边浴缸龙头  
出水嘴距离: 143×188mm



IOPEL Series 欧宝系列



**WMG5281**

Robe hook  
Size: 60×122×87mm  
单衣钩  
尺寸: 60×122×87mm



**WMG5283**

Toilet Tissue Holder  
Size: 207×145×223mm  
纸巾架  
尺寸: 207×145×223mm



**WMG5286**

Tumbler  
Size: 150×172×174mm  
漱口杯  
尺寸: 150×172×174mm



**WMG5285**

Soap dish  
Size: 174×199×135mm  
皂碟架  
尺寸: 174×199×135mm



**WMG5288**

Toilet Brush  
Size: 150×172×380mm  
卫生刷  
尺寸: 150×172×380mm



**WMG5289**

Towel Bar  
Size: 640×141×108mm  
单杆毛巾架  
尺寸: 640×141×108mm



**WMG5291**

Towel Shelf  
Size: 640×277×121mm  
多杆毛巾架  
尺寸: 640×277×121mm



---

# PROSPEROUS TANG SERIES

大唐盛世系列

---

Asia ladies are from respectable families, and also revealed the men with gentle and cultivated. The bone has revealed the Chinese style, From the inside out, is flickered the wisdom and elegance of the Chinese culture for several thousands of years, as good as the splendidly dazzles of the arts.







## WISDOM

Elegance came from the accumulation of wealth by wisdom. Luxury subverts the traditional cognition and aesthetics, it advocated different art of lives, The integration of these two products was splendidly decorated. Behind the aesthetics, the people attitude towards life is hidden.







TO CREATE A MORE  
ABSTRACT WAY OF  
EXPRESSION SPACE  
ARTISTIC CONCEPTION.

## ABSTRACT EXPRESSION





AE2051

Single lever basin faucet  
Spout Reach:  
(L)135mm / (H)118mm

单孔台下盆龙头  
出水嘴距离: 135×118mm



BE2052

Single lever basin faucet tall  
Spout Reach:  
(L)173mm / (H)224mm

单孔台上盆龙头  
出水嘴距离: 173×224mm



FE2076

Basin faucet wall mounted  
Spout Reach: 162mm

暗装面盆龙头  
出水嘴距离: 162mm



PE6616

3-hole basin faucet  
Spout Reach:  
(L)146mm / (H)121mm

三孔面盆龙头  
出水嘴距离: 146×121mm



CE2058/022/8951

Revealed shower set  
Head shower size: 280×180mm

明装淋浴花洒套装  
顶喷花洒尺寸: 280×180mm



LE2057/022/8951

Concealed shower set  
Head shower size: 280×180mm

暗装淋浴花洒套装  
顶喷花洒尺寸: 280×180mm



LE2056/022/8951

Concealed shower set  
Head shower size: 280×180mm

暗装淋浴花洒套装  
顶喷花洒尺寸: 280×180mm



NE6619

5-hole bathtub combination  
Spout Reach:  
(L)146mm / (H)121mm

缸边浴缸龙头  
出水嘴距离: 146×121mm



KE6121

Bathtub faucet floor-standing  
Spout Reach:  
(L)199mm / (H)846mm

落地浴缸龙头  
出水嘴距离: 199×846mm



PROSPEROUS TANG Series 大唐盛世系列



WE5251

Robe hook  
Size: 40×57×80mm

单衣钩  
尺寸: 40×57×80mm



WE5253

Toilet Tissue Holder  
Size: 133×67×130mm

纸巾架  
尺寸: 133×67×130mm



WE5254

Towel Ring  
Size: 170×68×218mm

毛巾环  
尺寸: 170×68×218mm



WE5258

Toilet Brush  
Size: 110×164×385mm

卫生刷  
尺寸: 110×164×385mm



WE5259

Towel Bar  
Size: 620×67×80mm

单杆毛巾架  
尺寸: 620×67×80mm



WE5261

Towel Shelf  
Size: 620×204×140mm

多杆浴巾架  
尺寸: 620×204×140mm



---

# BAMBOO SERIES

梅雨竹林系列

---

WATER IS THE SOURCE OF ALL THINGS. WE HAVE ALL SPENT TIME AND ENERGY THINKING AND DISCUSSING THE SHAPE OF WATER. THE GRACEFUL DESIGN REVEALS GREAT ATTENTION TO DETAIL, INSPIRING NEW GEOMETRIC SHAPES. A DYNAMIC LINE WITH GLOSS AND POLYHEDRAL SURFACES.





Well-defined structure is interpreted wisdom and dignity, which resulted that the product which kept a low profile, shinned again.



# WISDOM ARCHIVING

PERCEPTION SPACE AESTHETICS  
THERE ARE TEMPERATURE, DEPTH AND BREADTH

# BREADTH





AJ6211

Single lever basin faucet  
Spout Reach:  
[L]95mm / [H]112mm  
单孔台下盆龙头  
出水嘴距离: 95×112mm



BJ6212

Single lever basin faucet tall  
Spout Reach:  
[L]134mm / [H]203mm  
单孔台上盆龙头  
出水嘴距离: 134×203mm



PJ6216

3-hole basin faucet  
Spout Reach:  
[L]223mm / [H]161mm  
三孔面盆龙头  
出水嘴距离: 223×161mm



KJ6228

Bathtub faucet floor- standing  
Spout Reach:  
[L]143mm / [H]669mm  
落地浴缸龙头  
出水嘴距离: 143×669mm



CJ6238/103/8950

Concealed shower set  
Head shower size: Φ230mm  
明装淋浴花洒套装  
顶喷花洒尺寸: Φ230mm



LJ6234/103/8950

Revealed shower set  
Head shower size: Φ230mm  
暗装淋浴花洒套装  
顶喷花洒尺寸: Φ230mm



LJ6235/103/8950

Concealed shower set  
Head shower size: Φ230mm  
暗装淋浴花洒套装  
顶喷花洒尺寸: Φ230mm



WJ5401

Robe hook  
Size: 54×69×66mm  
单衣钩  
尺寸: 54×69×66mm



WJ5402

Double robe hook  
Size: 54×69×58mm  
双衣钩  
尺寸: 54×69×58mm



WJ5403

Toilet Tissue Holder  
Size: 133×79×100mm  
纸巾架  
尺寸: 133×79×100mm



WJ5404

Towel Ring  
Size: 170×69×192mm  
毛巾环  
尺寸: 170×69×192mm



WJ5405

Soap dish  
Size: 116×170×69mm  
皂碟架  
尺寸: 116×170×69mm



WJ5406

Tumbler  
Size: 69×146×95mm  
漱口杯  
尺寸: 69×146×95mm



WJ5407

Double Tumbler  
Size: 180×94×97mm  
双漱口杯  
尺寸: 180×94×97mm



WJ5408

Toilet Brush  
Size: 100×169×377mm  
卫生刷  
尺寸: 100×169×377mm



WJ5409

Towel Bar  
Size: 634×69×54mm  
单杆毛巾架  
尺寸: 634×69×54mm



WJ5411

Towel Shelf  
Size: 634×205×114mm  
多杆浴巾架  
尺寸: 634×205×114mm





---

# NOAH SERIES

诺亚方舟系列

---

The combination of simple modeling and scientific spatial structure allows the traditional product technology to bloom through the Millennium Fashion Beauty, each shape, each line is permeated with the flavor of the times, highlighting the artistic charm, originality, to create such a stylish and elegant modern style.



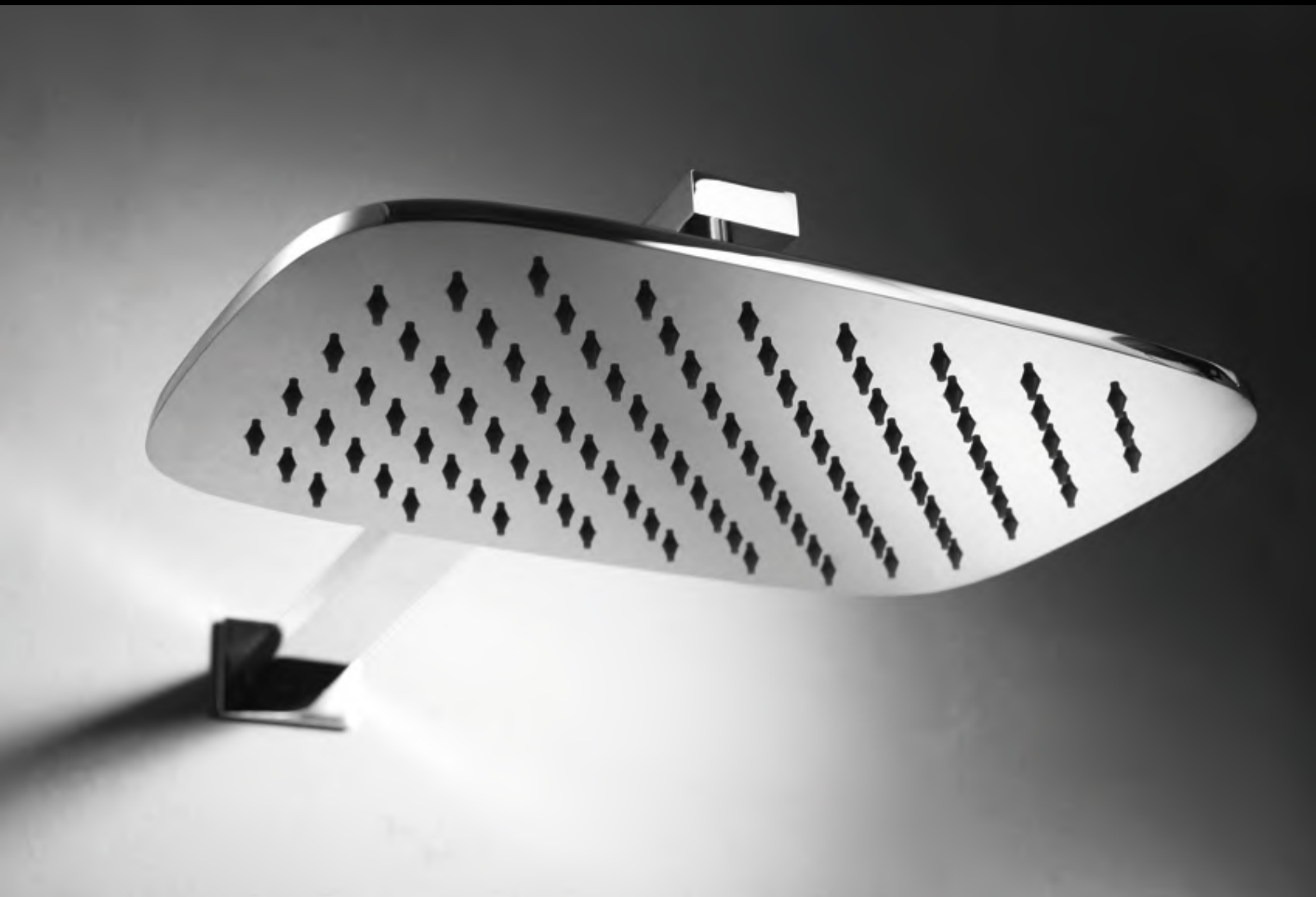

# FINE



WITH RIGOROUS, FINE  
TECHNOLOGY AND  
MANUFACTURING STANDARDS,  
CONSTANTLY CREATE SANITARY  
PRODUCTS.

# DETACHMENT



# CHEERFUL

Spotless, quiet and beautiful, create the ideal world we yearn for, give a person a sense of immersion to enjoy.



**AC6611**

Single lever basin faucet  
Spout Reach:  
[L]135mm / [H]118mm

单孔台下盆龙头  
出水嘴距离: 135×118mm



**BC6612**

Single lever basin faucet tall  
Spout Reach:  
[L]173mm / [H]224mm

单孔台上盆龙头  
出水嘴距离: 173×224mm



**PC6616**

3-hole basin faucet  
Spout Reach:  
[L]146mm / [H]121mm

三孔面盆龙头  
出水嘴距离: 146×121mm



**FC2076**

Basin faucet wall mounted  
Spout Reach: 162mm

暗装面盆龙头  
出水嘴距离: 162mm



**FC2077**

Basin faucet wall mounted  
Spout Reach: 200mm

暗装面盆龙头  
出水嘴距离: 200mm



**LC2057/108/8951**

Concealed shower set  
Head shower size:  
[L]300mm / [H]200mm

暗装淋浴花洒套装  
顶喷花洒尺寸: 300×200mm



**LC2056/108/8951**

Concealed shower set  
Head shower size:  
[L]300mm / [H]200mm

暗装淋浴花洒套装  
顶喷花洒尺寸: 300×200mm



**NC6619**

5-hole bathtub combination  
Spout Reach:  
[L]146mm / [H]121mm

缸边浴缸龙头  
出水嘴距离: 146×121mm



**KC6121**

Bathtub faucet floor- standing  
Spout Reach:  
[L]199mm / [H]846mm

落地浴缸龙头  
出水嘴距离: 199×846mm



**WC5301**

Robe hook  
Size: 48×57×56mm

单衣钩  
尺寸: 48×57×56mm



**WC5302**

Double robe hook  
Size: 95×57×48mm

双衣钩  
尺寸: 95×57×48mm



**WC5303**

Toilet Tissue Holder  
Size: 146×94×136mm

纸巾架  
尺寸: 146×94×136mm



**WC5304**

Towel Ring  
Size: 160×66×170mm

毛巾环  
尺寸: 160×66×170mm



**WC5305**

Soap dish  
Size: 110×130×65mm

皂碟架  
尺寸: 110×130×65mm



**WC5306**

Tumbler  
Size: 68×130×96mm

漱口杯  
尺寸: 68×130×96mm



**WC5307**

Double Tumbler  
Size: 165×80×96mm

双漱口杯  
尺寸: 165×80×96mm



**WC5308**

Toilet Brush  
Size: 117×153×360mm

卫生刷  
尺寸: 117×153×360mm



**WC5309**

Towel Bar  
Size: 627×67×48mm

单杆毛巾架  
尺寸: 627×67×48mm



**WC5316**

Towel Shelf  
Size: 648×210×108mm

多杆浴巾架  
尺寸: 648×210×108mm



---

# WEAVER SERIES

唯沃系列

---

NOT ONLY IN THE VISUAL ELEGANT DESIGN BUT ALSO ADDED MORE HUMAN DESIGN, SO THAT THE PRODUCT NOT ONLY MEETS THE NEEDS OF LIFE FUNCTIONS BUT ALSO INTEGRATES THE HUMANISTIC SPIRIT, MAKING YOUR LIFE RICHER.





**SIMPLICITY IS,**  
THE SOUL OF DESIGN.







**AMC2071**

Single lever basin faucet  
Spout Reach:  
(L)126mm / (H)121mm  
单孔台下盆龙头  
出水嘴距离: 126×121mm



**AMC2081**

Single lever basin faucet with pull-out type  
Spout Reach:  
(L)122mm / (H)115mm  
单孔台下盆龙头  
出水嘴距离: 122×115mm



**BMC2072**

Single lever basin faucet tall  
Spout Reach:  
(L)165mm / (H)221mm  
单孔台上盆龙头  
出水嘴距离: 165×221mm



**BMC2082**

Single lever basin faucet tall with pull-out type  
Spout Reach:  
(L)152mm / (H)215mm  
单孔台上盆龙头  
出水嘴距离: 152×215mm



**CMC2085/086/8986**

Revealed shower set  
Head shower size:  
(L)290mm / (H)190mm  
明装淋浴花洒套装  
顶喷花洒尺寸: 290×190mm



**CMC2086/086/8986**

Revealed shower set  
Head shower size:  
(L)290mm / (H)190mm  
明装淋浴花洒套装  
顶喷花洒尺寸: 290×190mm



**LM2088/086/8986**

Concealed shower set  
Head shower size:  
(L)290mm / (H)190mm  
暗装淋浴花洒套装  
顶喷花洒尺寸: 290×190mm



**LM2089/086/8986**

Concealed shower set  
Head shower size:  
(L)290mm / (H)190mm  
暗装淋浴花洒套装  
顶喷花洒尺寸: 290×190mm



**PM2083**

3-hole basin faucet  
Spout Reach:  
(L)164mm / (H)184mm  
三孔面盆龙头  
出水嘴距离: 164×184mm



**FM2087**

Basin faucet wall mounted  
Spout Reach: 192mm  
暗装面盆龙头  
出水嘴距离: 192mm



**FM2076**

Basin faucet wall mounted  
Spout Reach: 162mm  
暗装面盆龙头  
出水嘴距离: 162mm



**FM2077**

Basin faucet wall mounted  
Spout Reach: 200mm  
暗装面盆龙头  
出水嘴距离: 200mm



WEAVER *Series* 唯沃系列



WM5901

Robe hook  
Size: 45×62×52mm

单衣钩  
尺寸: 45×62×52mm



WM5823

Toilet Tissue Holder  
Size: 190×122×93mm

纸巾架  
尺寸: 190×122×93mm



WM5828

Toilet Brush  
Size: 115×145×360mm

卫生刷  
尺寸: 115×145×360mm



WM5829

Towel Bar  
Size: 600×75×48mm

单杆毛巾架  
尺寸: 600×75×48mm



WM5831

Towel Shelf  
Size: 603×220×125mm

多杆浴巾架  
尺寸: 603×220×125mm



---

# LANE SERIES

水浴风尚系列

---

ELIMINATING VANITY, MADE OF NATURAL MATERIAL,  
WHICH REFLECTED THE LOW-KEY AND PURE LIFE ATTITUDES.  
COSO BRINGS THE CONVENIENT EXPERIENCE FROM HIS  
DESIGN, WHICH ENSURE YOU ENJOY THE COMFORT FROM THE  
BATHROOM SPACE



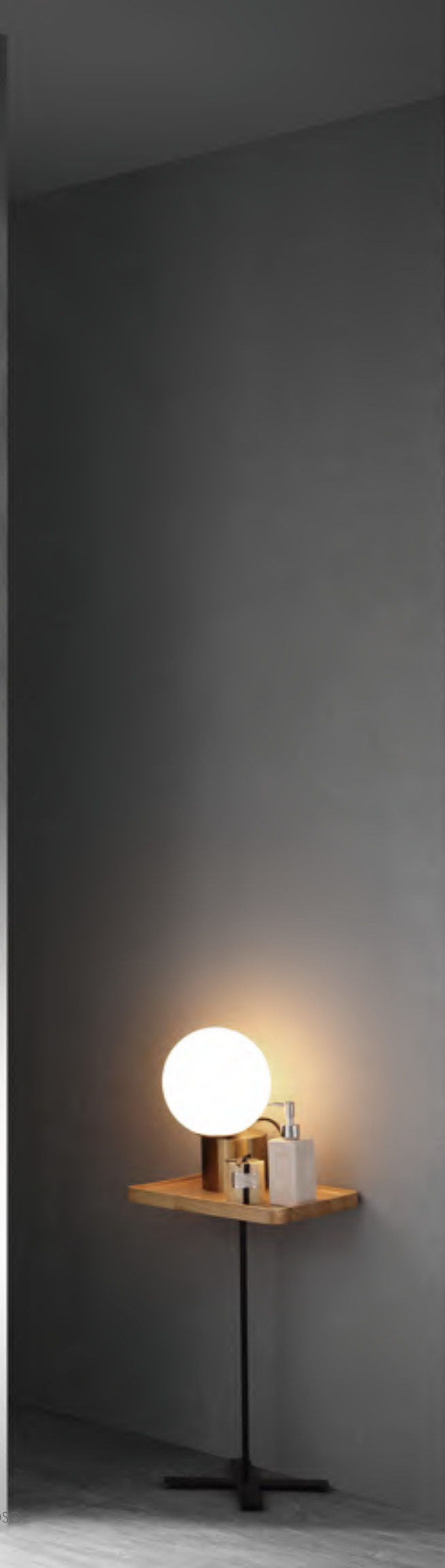

Just like the artwork like sculpture in the bathroom, apply contracted and clear linear design and a variety of exterior modelling to model beautiful scenery. The soft water is impressive.

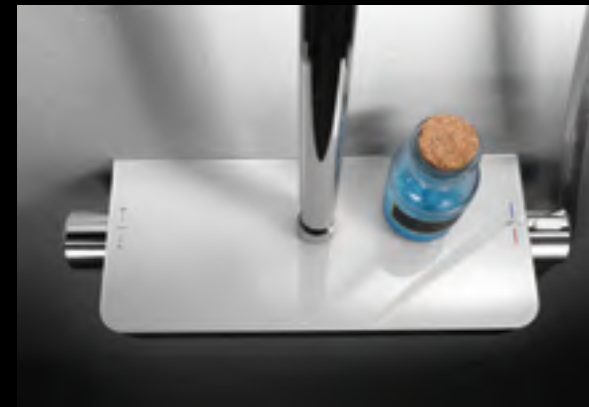

**ARTWORK  
LIKE**

# WATERFALL



Bibcock resembles broad grass leaf, current is like natural waterfall, bath crock is like quiet lake, fittings is reflecting the mutual influence between nature. The bathroom is a place of meditation.





# CHARMING



It is natural and elegant, creating a charming elegant temperament for the space.



**AC1861**

Single lever basin faucet  
Spout Reach:  
(L)141mm / (H)102mm

单孔台下盆龙头  
出水嘴距离: 141×102mm



**BC1862**

Single lever basin faucet tall  
Spout Reach:  
(L)141mm / (H)262mm

单孔台上盆龙头  
出水嘴距离: 141×262mm



**PC1867**

3-hole basin faucet  
Spout Reach:  
(L)107mm / (H)83mm

三孔面盆龙头  
出水嘴距离: 107×83mm



**NC1869**

5-hole bathtub combination  
Spout Reach:  
(L)107mm / (H)83mm

缸边浴缸龙头  
出水嘴距离: 107×83mm



**CC1875/1007/9007**

Perfect shower set with Thermostatic  
Head shower size:  
(L)255mm / (H)255mm

明装淋浴花洒套装 (恒温)  
顶喷花洒尺寸: 255×255mm



**iC1873/3705/9007**

Concealed shower set  
Head shower size:  
(L)255mm / (H)255mm

简易淋浴花洒 (恒温)



**iC1873/3719/9007**

Concealed shower set  
Head shower size:  
(L)255mm / (H)255mm

简易淋浴花洒 (恒温)



**KC1868**

Bathtub faucet floor-standing  
Spout Reach:  
(L)198mm / (H)1096mm

落地浴缸龙头  
出水嘴距离: 198×1096mm



**LC1876/1007/9007**

Concealed shower set with Thermostatic  
Head shower size:  
(L)255mm / (H)255mm

暗装淋浴花洒套装 (恒温)  
顶喷花洒尺寸: 255×255mm



**LC1877/1007/9007**

Concealed shower set  
Head shower size:  
(L)255mm / (H)255mm

暗装淋浴花洒套装  
顶喷花洒尺寸: 255×255mm



**LC1878/1007/9007**

Concealed shower set  
Head shower size:  
(L)255mm / (H)255mm

暗装淋浴花洒套装  
顶喷花洒尺寸: 255×255mm



**WC5901**

Robe hook  
Size: 45×62×52mm

单衣钩  
尺寸: 45×62×52mm



**WC5823**

Toilet Tissue Holder  
Size: 190×122×93mm

纸巾架  
尺寸: 190×122×93mm



**WC5829**

Towel Bar  
Size: 600×75×48mm

单杆毛巾架  
尺寸: 600×75×48mm



**WC5831**

Towel Shelf  
Size: 603×220×125mm

多杆浴巾架  
尺寸: 603×220×125mm



**WC5828**

Toilet Brush  
Size: 115×145×360mm

卫生刷  
尺寸: 115×145×360mm





---

# MIG SERIES

米格系列

---

PURE EXTREMELY SIMPLE, HAD BECOME A LOT OF PLACE IN THE HEART THAT LIVE TO, THEY ARE PURE, NATURAL, PLAIN, STILL CAN HIGHLIGHT ARTISTIC BREATH, ESPECIALLY BELOW THE FAST RHYTHM LIFE CONDITION THAT IS BUSY IN THE CITY NOW, SMALL SPACE CAN LET BLAMELESS HEART CALM SLOWLY COME DOWN.



NORDIC TRAVEL NOTES,  
LIFE IS A WONDERFUL  
JOURNEY, IT WILL TELL  
YOU THAT THE WORLD IS  
WIDER THAN YOU THINK.  
IN THE EDIFICATION OF  
ART, HE LIVES WITH AN  
ELEGANT ATTITUDE AND  
CARVES HIS LIFE INTO A  
BEAUTIFUL WORK OF ART.



# EDIFICATION





**MIG Series** 米格系列



**AC8571**  
Single lever basin faucet  
Spout Reach:  
(L)128mm / (H)61mm  
单孔台下盆龙头  
出水嘴距离: 128×61mm



**BC8572**  
Single lever basin faucet tall  
Spout Reach:  
(L)128mm / (H)226mm  
单孔台上盆龙头  
出水嘴距离: 128×226mm



**PC1098**  
3-hole basin faucet  
Spout Reach:  
(L)149mm / (H)176mm  
三孔面盆龙头  
出水嘴距离: 149×176mm



**FC6066**  
Basin faucet wall mounted  
Spout Reach: 177mm  
暗装面盆龙头  
出水嘴距离: 177mm



**NC1099**  
5-hole bathtub combination  
Spout Reach:  
(L)149mm / (H)176mm  
缸边浴缸龙头  
出水嘴距离: 149×176mm



**KC6068**  
Bathtub faucet floor-standing  
Spout Reach:  
(L)146mm / (H)983mm  
落地浴缸龙头  
出水嘴距离: 146×983mm



**LC8226/105/8950**  
Concealed shower set  
Head shower size: 300mm  
暗装淋浴花洒套装  
顶喷花洒尺寸: Φ300mm



**LC8227/105/8950**  
Concealed shower set  
Head shower size: 300mm  
暗装淋浴花洒套装  
顶喷花洒尺寸: Φ300mm



---

# LIVABLE SERIES

宜居系列

---

THERE IS NO EXTRAVAGANCE AND FLAUNT, COMFORT AND NATURE ARE ENOUGH TO RELEASE, RELATIVES AND INDULGENCE. WHEN FAR AWAY FROM THE TENSION AND AMBIGUITY OF THE CITY, TRANQUILITY, AND KINDNESS IS ENOUGH TO RELAX, ENJOYMENT AND REST.



# PLEASURE

RATIONAL AND PERCEPTUAL  
PROPER FUSION, LOOK LIKE  
AVANT-GARDE MODELLING  
ACTUALLY THROUGH CAREFUL  
DESIGN, MAXIMUM SAVINGS OF  
RESOURCES. JUST AS NATURE  
INTENDED.





LIKE A SENSORY WATERFALL,  
LET THE COMBINATION OF  
PEOPLE AND NATURE TO  
BENEFIT. THE AVANT-GARDE  
ORGANIC DESIGN BRINGS  
USERS A PLEASANT WATER  
EXPERIENCE.

# WATER FLOW BEAUTY





LIVABLE *Series* 宜居系列



**AC8328**

Single lever basin faucet  
Spout Reach:  
(L)111mm / (H)112mm  
单孔台下盆龙头  
出水嘴距离: 111×112mm



**AC6601**

Single lever basin faucet  
Spout Reach:  
(L)125mm / (H)123mm  
单孔台下盆龙头  
出水嘴距离: 125×123mm



**AC1051**

Single lever basin faucet  
Spout Reach:  
(L)145mm / (H)102mm  
单孔台下盆龙头  
出水嘴距离: 145×102mm



**AC2201**

**AM2201**

Single lever basin faucet  
Spout Reach:  
(L)106mm / (H)90mm  
单孔台下盆龙头  
出水嘴距离: 106×90mm



**BC8329**

Single lever basin faucet tall  
Spout Reach:  
(L)140mm / (H)231mm  
单孔台上盆龙头  
出水嘴距离: 140×231mm



**BC6602**

Single lever basin faucet tall  
Spout Reach:  
(L)125mm / (H)175mm  
单孔台上盆龙头  
出水嘴距离: 125×175mm



**BC1052**

Single lever basin faucet tall  
Spout Reach:  
(L)145mm / (H)163mm  
单孔台上盆龙头  
出水嘴距离: 145×163mm



**PC8560**

**PM8560**

Single lever basin faucet tall  
Spout Reach:  
(L)141mm / (H)175mm  
三孔面盆龙头  
出水嘴距离: 141×175mm



**iC8225**

Shower faucet  
明装浴缸龙头



**HC8418**

Shower faucet  
明装淋浴龙头



**HC6622**

Shower faucet  
明装淋浴龙头



**iC6621**

Shower faucet  
明装浴缸龙头





HC8418/3707/8947

Shower set  
简易淋浴花洒



HC6622/3721/8945

Shower set  
简易淋浴花洒



HC8582/3705/9001

Thermostatic shower set  
简易淋浴花洒 (恒温)



iC1873/3705/9007

Thermostatic shower set  
简易淋浴花洒 (恒温)



CC2205/037/8942

Revealed shower set  
Head shower size:  $\Phi$ 200mm

明装淋浴花洒套装  
顶喷花洒尺寸:  $\Phi$ 200mm



CC1212/039/8947

Revealed shower set  
Head shower size: 295x195mm

明装淋浴花洒套装  
顶喷花洒尺寸: 295x195mm



CC6605/039/8945

Revealed shower set  
Head shower size: 295x195mm

明装淋浴花洒套装  
顶喷花洒尺寸: 295x195mm



CM2205/053/8953

Revealed shower set  
Head shower size:  $\Phi$ 220mm

明装淋浴花洒套装  
顶喷花洒尺寸:  $\Phi$ 220mm



iC8225/3718/8947

Shower set  
简易淋浴花洒



iC6621/3718/8945

Shower set  
简易淋浴花洒



HC8582/3719/9001

Shower set  
简易淋浴花洒 (恒温)



iC1873/3719/9007

Thermostatic shower set  
简易淋浴花洒 (恒温)



CC2206/037/8942

Revealed shower set  
Head shower size:  $\Phi$ 200mm

明装淋浴花洒套装  
顶喷花洒尺寸:  $\Phi$ 200mm



CC8555/8945

Revealed shower set  
明装淋浴花洒套装



**WC5901**  
Robe hook  
Size: 45×62×52mm  
单衣钩  
尺寸: 45×62×52mm



**WC5902**  
Double robe hook  
Size: 47×62×45mm  
双衣钩  
尺寸: 47×62×45mm



**WC5903**  
Toilet Tissue Holder  
Size: 138×95×140mm  
纸巾架  
尺寸: 138×95×140mm



**WC5904**  
Towel Ring  
Size: 160×64×180mm  
毛巾环  
尺寸: 160×64×180mm



**WM5343**  
Double Toilet Tissue Holder  
Size: 268×112×90mm  
双纸巾架  
尺寸: 268×112×90mm



**WM5345**  
Toilet Brush  
Size: 114×152×377mm  
卫生刷  
尺寸: 114×152×377mm



**WM5347**  
Towel Bar  
Size: 616×72×45mm  
单杆毛巾架  
尺寸: 616×72×45mm



**WM5349**  
Towel Shelf  
Size: 616×211×125mm  
多杆浴巾架  
尺寸: 616×211×125mm



**WC5905**  
Soap dish  
Size: 96×124×67mm  
皂碟架  
尺寸: 96×124×67mm



**WC5906**  
Tumbler  
Size: 68×125×95mm  
漱口杯  
尺寸: 68×125×95mm



**WC5907**  
Double Tumbler  
Size: 176×90×95mm  
双漱口杯  
尺寸: 176×90×95mm



**WC5908**  
Toilet Brush  
Size: 110×164×385mm  
卫生刷  
尺寸: 110×164×385mm



**WC5909**  
Towel Bar  
Size: 645×62×45mm  
单杆毛巾架  
尺寸: 645×62×45mm



**WC5910**  
Towel Shelf  
Size: 645×110×45mm  
双杆毛巾架  
尺寸: 645×110×45mm



**WC5911**  
Towel Shelf  
Size: 645×198×105mm  
多杆浴巾架  
尺寸: 645×198×105mm

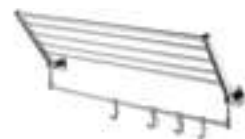

**WC5612**  
Towel Shelf  
Size: 640×50×297mm  
多杆浴巾架  
尺寸: 640×50×297mm



Infiltrate every wei yu space, build a happy, free and relaxed atmosphere.

# CLARITY RELAXED





A COLLECTION THAT OFFERS A VARIETY OF OPTIONS,  
COMBINED WITH A SERENE AND MODERN DESIGN,  
MAKES IT FIT INTO EVERY BATHROOM SPACE.





EXPOSED SHOWER System 明装淋浴花洒系统



CC8567/039/9007

Thermostatic revealed shower set  
Head shower size:  
[L]295mm / [H]195mm

明装淋浴花洒套装 (恒温)  
顶喷花洒尺寸: 295×195mm



CC8570/049/9007

Thermostatic revealed shower set  
Head shower size:  
[L]400mm / [H]250mm

明装淋浴花洒套装 (恒温)  
顶喷花洒尺寸: 400×250mm



CC1875/1007/9007

Thermostatic revealed shower set  
Head shower size:  
[L]255mm / [H]255mm

明装淋浴花洒套装 (恒温)  
顶喷花洒尺寸: 255×255mm



CC8565/1001/9001

Thermostatic revealed shower set  
Head shower size:  
[L]360mm / [H]210mm

明装淋浴花洒套装 (恒温)  
顶喷花洒尺寸: 360×210mm



CC8581/1001/9001

Revealed shower set  
Head shower size:  
[L]360mm / [H]210mm

明装淋浴花洒套装  
顶喷花洒尺寸: 360×210mm

# CONCEALED SHOWER SYSTEM



THERMOSTAT  
CONCEALED SHOWER

恒温旋转切换淋浴花洒



CONCEALED SHOWER  
WITH ROTATING SWITCH

标准旋转切换淋浴花洒



CONCEALED SHOWER  
WITH PUSHING SWITCH

标准按压切换淋浴花洒



! THERMOSTAT CONCEALED SHOWER 暗装淋浴花洒套装 (恒温)



LM6650/1006/9006

Thermostat concealed shower  
Head shower size:  $\Phi$ 250mm

暗装淋浴花洒套装 (恒温)  
顶喷尺寸:  $\Phi$ 255mm



LM6651/1006/9006

Thermostat concealed shower  
Head shower size:  $\Phi$ 250mm

暗装淋浴花洒套装 (恒温)  
顶喷尺寸:  $\Phi$ 255mm



LM6652/1007/9007

Thermostat concealed shower  
Head shower size: 255x255mm

暗装淋浴花洒套装 (恒温)  
顶喷尺寸: 255x255mm



LM6653/1007/9007

Thermostat concealed shower  
Head shower size: 255x255mm

暗装淋浴花洒套装 (恒温)  
顶喷尺寸: 255x255mm



! THERMOSTAT CONCEALED SHOWER 暗装淋浴花洒套装 (恒温)



LC6660/1008/9008

Thermostat concealed shower  
Head shower size:  $\Phi$ 255mm

暗装淋浴花洒套装 (恒温)  
顶喷尺寸:  $\Phi$ 255mm



LC6661/105/9001

Thermostat concealed shower  
Head shower size:  $\Phi$ 300mm

暗装淋浴花洒套装 (恒温)  
顶喷尺寸:  $\Phi$ 300mm



LC6662/1003/9003

Thermostat concealed shower  
Head shower size: 300x190mm

暗装淋浴花洒套装 (恒温)  
顶喷尺寸: 300x190mm



LC6663/1001/9001

Thermostat concealed shower  
Head shower size: 360x210mm

暗装淋浴花洒套装 (恒温)  
顶喷尺寸: 360x210mm





CONCEALED SHOWER 暗装淋浴花洒套装



**LC6670/073/8951**  
 Concealed shower set  
 Head shower size: 300×300mm  
 暗装淋浴花洒套装  
 顶喷尺寸: 300×300mm



**LC6671/1003/9003**  
 Concealed shower set  
 Head shower size: 300×190mm  
 暗装淋浴花洒套装  
 顶喷尺寸: 300×190mm



**LC6672/1001/9001**  
 Concealed shower set  
 Head shower size: 360×210mm  
 暗装淋浴花洒套装  
 顶喷尺寸: 360×210mm



**LC6673/1009/9009**  
 Concealed shower set  
 Head shower size: 300×200mm  
 暗装淋浴花洒套装  
 顶喷尺寸: 300×200mm



**LC6675/105/9001**  
 Concealed shower set  
 Head shower size: Φ300mm  
 暗装淋浴花洒套装  
 顶喷尺寸: Φ300mm



**LC6676/1003/9003**  
 Concealed shower set  
 Head shower size: 300×190mm  
 暗装淋浴花洒套装  
 顶喷尺寸: 300×190mm



**LC6677/037/9006**  
 Concealed shower set  
 Head shower size: Φ200mm  
 暗装淋浴花洒套装  
 顶喷尺寸: Φ200mm



**LC6678/1006/9006**  
 Concealed shower set  
 Head shower size: Φ255mm  
 暗装淋浴花洒套装  
 顶喷尺寸: Φ255mm



CONCEALED SHOWER 暗装淋浴花洒套装



LC6680/1003/9003

Concealed shower set  
Head shower size: 300x190mm

暗装淋浴花洒套装  
顶喷尺寸: 300x190mm



LC6681/1007/9007

Concealed shower set  
Head shower size: 255x255mm

暗装淋浴花洒套装  
顶喷尺寸: 255x255mm



LC6682/1009/9009

Concealed shower set  
Head shower size: 300x200mm

暗装淋浴花洒套装  
顶喷尺寸: 300x200mm



LC6683/073/8951

Concealed shower set  
Head shower size: 300x300mm

暗装淋浴花洒套装  
顶喷尺寸: 300x300mm

# CUSTOMIZATION SHOWER SYSTEMS



1

MAIN  
BODY

主体



2

HEAD  
SHOWER

头顶花洒



3

HAND HELD  
SHOWERS

手持花洒

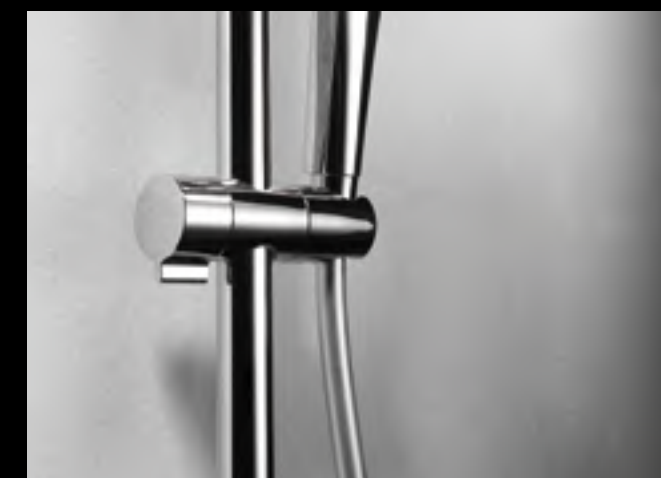

4

SHOWER  
CONFIGURATION

淋浴花洒配置

# E-BOX

## 预埋盒

The e-box is the core of the concealed shower set, combined with the installation of the concealed water pipe, and the main body is placed in the wall, only the control panel is exposed, which adds beauty and saves space.

预埋盒就是把暗装淋浴花洒的核心，配合暗装水管的安装，把主体都收到墙内，只露出控制面板，增添美感且节省空间，非常适合对家装外观追求比较高的人群。



# MAIN BODY

主体

The concealed shower has two different display shapes, one is round and one is rectangle, you can choose the shape you like. The control panel is minimalist in design, combining simple lines with metallic colors, so that each control panel perfectly matches the COSO concealed shower.

暗装花洒的控制面板有两种不同的展示形状，一个是圆形和一个长方形，可以选择到您喜欢的形状。控制面板是极简的设计，结合了简约的线条与金属色，使每个控制面板完美的匹配到 COSO 的暗装淋浴花洒里。



! INTELLIGENT TEMPERATURE CONTROL 智能调温



暗装淋浴预埋件



**LC3202-2**

暗装淋浴主体  
\* 含暗装淋浴预埋件



**LC3203-2**

暗装淋浴主体  
\* 含暗装淋浴预埋件



暗装淋浴预埋件



**LC3202-3**

暗装淋浴主体  
\* 含暗装淋浴预埋件



**LC3203-3**

暗装淋浴主体  
\* 含暗装淋浴预埋件

! STANDARD TEMPERATURE 标准调温



暗装淋浴预埋件



**LC3104**

暗装淋浴主体  
\* 含暗装淋浴预埋件



**LC3103**

暗装淋浴主体  
\* 含暗装淋浴预埋件



暗装淋浴预埋件



**LC3304-2**

暗装淋浴主体  
\* 含暗装淋浴预埋件



**LC3310-2**

暗装淋浴主体  
\* 含暗装淋浴预埋件



**LC3302-2**

暗装淋浴主体  
\* 含暗装淋浴预埋件



**LC3300-2**

暗装淋浴主体  
\* 含暗装淋浴预埋件



暗装淋浴预埋件



**LC3401**

暗装淋浴主体  
\* 含暗装淋浴预埋件



暗装淋浴预埋件



**LC3304-3**

暗装淋浴主体  
\* 含暗装淋浴预埋件



**LC3310-3**

暗装淋浴主体  
\* 含暗装淋浴预埋件



**LC3302-3**

暗装淋浴主体  
\* 含暗装淋浴预埋件



**LC3300-3**

暗装淋浴主体  
\* 含暗装淋浴预埋件

# HEAD SHOWERS

头顶花洒



# HEAD SHOWERS

头顶花洒

## SELF CLEANING NEEDLE (RED)

Each time the water is turned off, the descaling needle (red) is automatically cleared once, saving effort and labor, and enhancing the life of the product.

### 自洁除垢针（红色部分）

每次停水时，除垢针（红色）会自动清除一次，从而节省人力和精力，并延长产品的使用寿命。

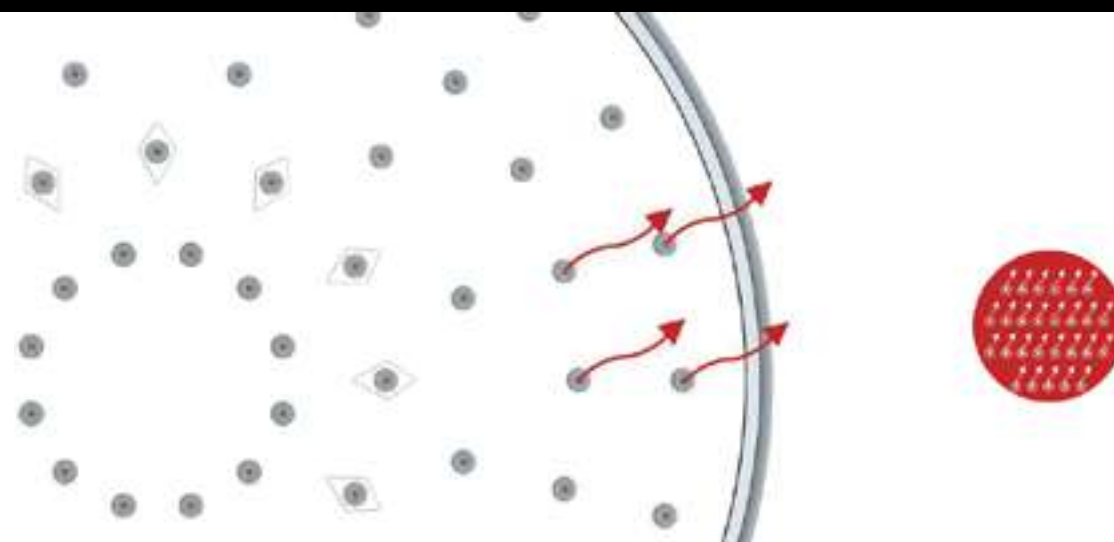

## SELF CLEANING NEEDLE





# HEAD SHOWERS

头顶花洒

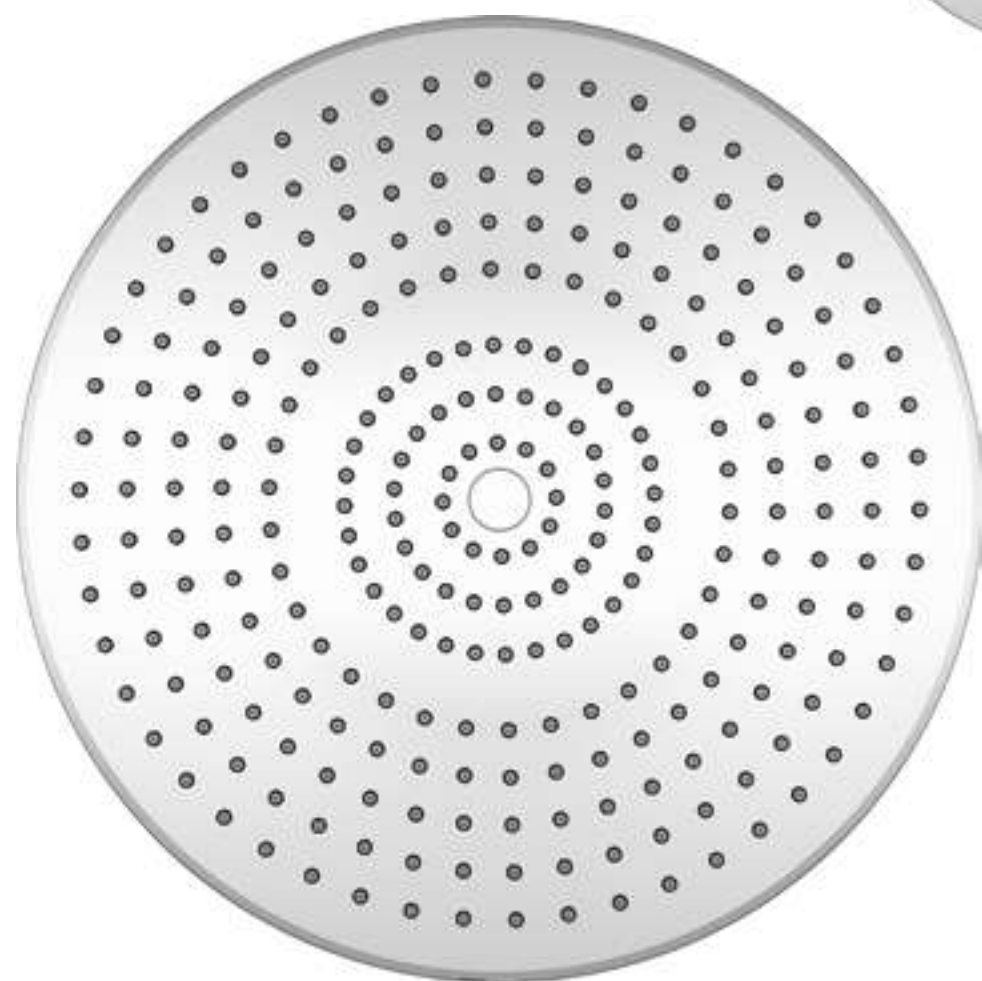

Water, the cradle of all things in the world, the source of health and comfort.



Like a sensory waterfall, the combination of human and nature benefits. Avant-garde organic design brings users a pleasant water experience.

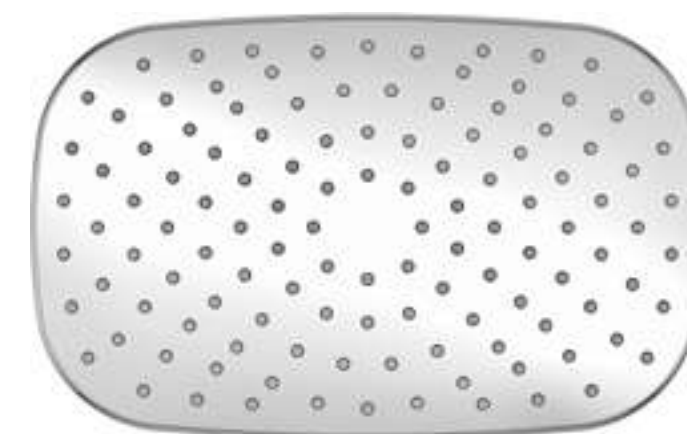
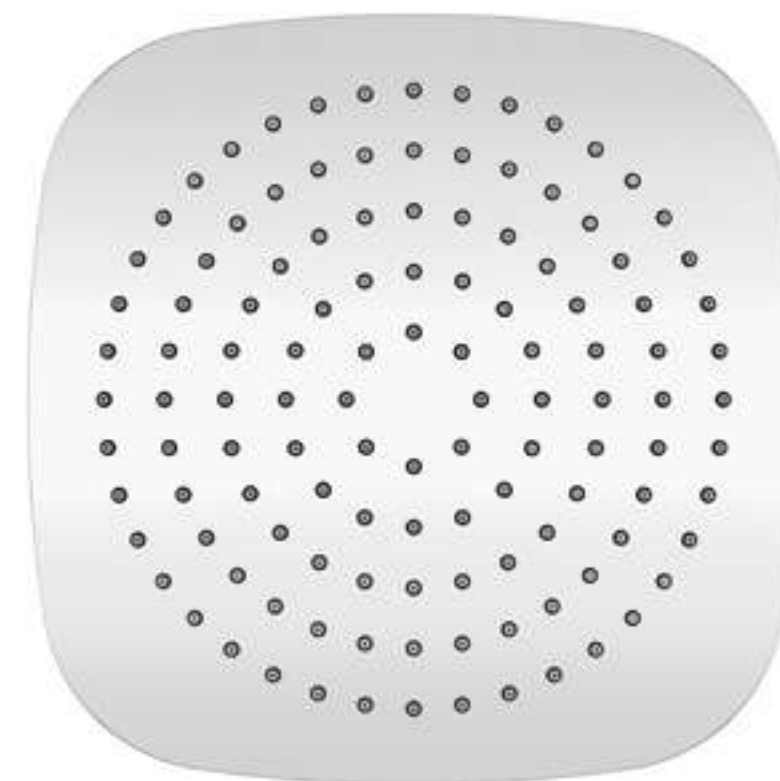

! HEAD SHOWER 头顶花洒



**S048**  
Head shower  
Size: 300x200mm  
头顶花洒  
size: 300x200mm

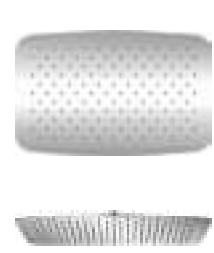

**S049**  
Head shower  
Size: 400x250mm  
头顶花洒  
size: 400x250mm



**S068**  
Head shower  
Size:  $\Phi$ 250mm  
头顶花洒  
size:  $\Phi$ 250mm

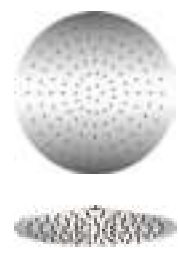

**S069**  
Head shower  
Size:  $\Phi$ 300mm  
头顶花洒  
size:  $\Phi$ 300mm



**S071**  
Head shower  
Size: 250x250mm  
头顶花洒  
size: 250x250mm



**S073**  
Head shower  
Size: 300x300mm  
头顶花洒  
size: 300x300mm

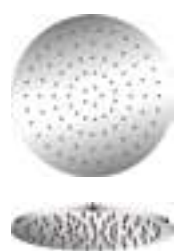

**S101**  
Head shower  
Size:  $\Phi$ 250mm  
头顶花洒  
size:  $\Phi$ 250mm

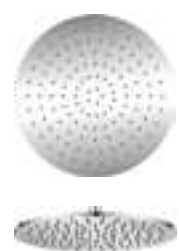

**S105**  
Head shower  
Size:  $\Phi$ 300mm  
头顶花洒  
size:  $\Phi$ 300mm



**S108**  
Head shower  
Size: 300x200mm  
头顶花洒  
size: 300x200mm

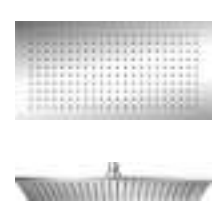

**S109**  
Head shower  
Size: 400x200mm  
头顶花洒  
size: 400x200mm

! HEAD SHOWER 头顶花洒



**S1001**  
Head shower  
Size: 360x210mm  
头顶花洒  
size: 360x210mm



**S1003**  
Head shower  
Size: 300x190mm  
头顶花洒  
size: 300x190mm



**S1009**  
Head shower  
Size: 300x200mm  
头顶花洒  
size: 300x200mm



**S1007**  
Head shower  
Size: 255x255mm  
头顶花洒  
size: 255x255mm



**S1006**  
Head shower  
Size:  $\Phi$ 255mm  
头顶花洒  
size:  $\Phi$ 255mm



**S1008**  
Head shower  
Size:  $\Phi$ 255mm  
头顶花洒  
size:  $\Phi$ 255mm

! SHOWER ARM 花洒臂



**3501**  
Shower arm  
Size: 400mm  
花洒臂  
size: 400mm



**3501A**  
Shower arm  
Size: 400mm  
花洒臂  
size: 400mm



**3502**  
Shower arm  
Size: 300mm  
花洒臂  
size: 300mm



**3503**  
Shower arm  
Size: 400mm  
花洒臂  
size: 400mm

# HAND HELD SHOWER

手持花洒





## HAND HELD SHOWER EFFECT OF WATER

手持花洒的出水效果

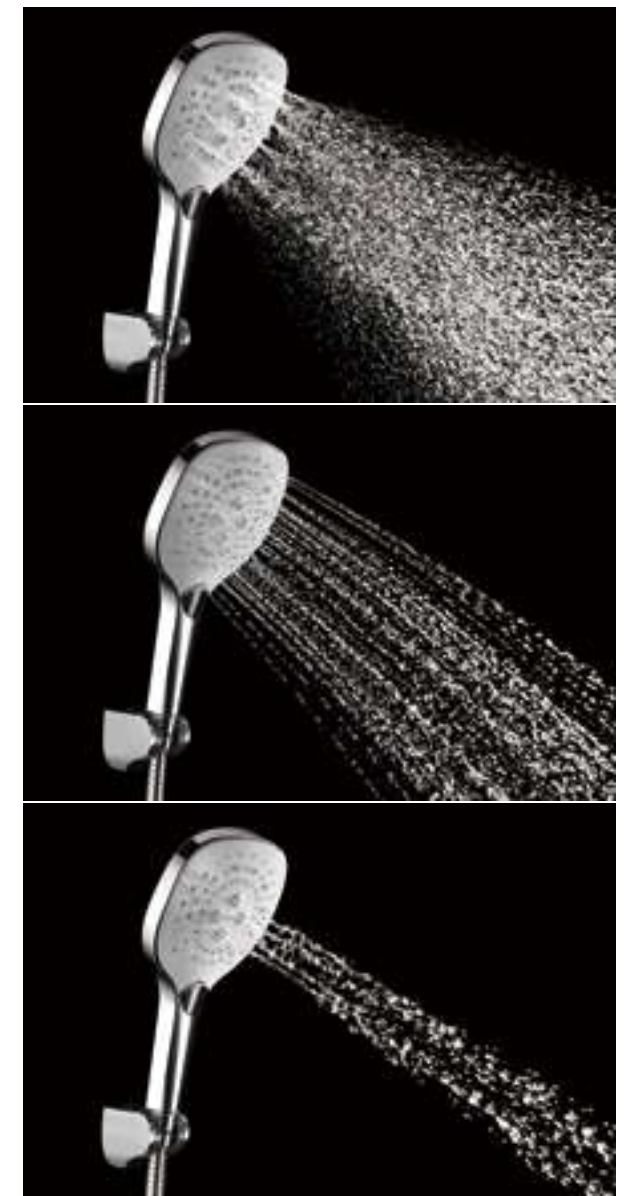

# HAND HELD SHOWER CHARACTERISTICS

## 手持花洒特点

### TWO WATER PIPES DESIGN

The gap between the surface of the hand shower and the hot water flowing inside is formed, and the handle is not too hot even after a long time hot water shower. Moreover, the water flow does not pass through the electroplating body, effectively avoiding water pollution caused by electroplating.

### 含内水路，防烫安全

花洒表面与内部流出的热水之间形成了缝隙，即使热水淋浴时间长了把手也不会太烫，而且水流不通过电镀体，有效避免电镀造成的水污染。



### THE NOZZLE OF THE HAND SHOWER IS MADE OF ENVIRONMENTALLY FRIENDLY LIQUID SILICONE MATERIAL

Using this material, the water is smooth and not easy to block, and the dirt can be removed with a single touch, which is safe and durable.

### 花洒喷嘴是环保液态硅胶材料

使用这种材料，水流顺滑，不易堵塞，一触即去，安全耐用。

### SWIRLING MESSAGE SHOWER MODE

With a mechanical rotating structure, the powerful massage water column rotates back and forth, making a good massage effect on the body.

### 旋转脉动按摩淋浴模式

结合机械旋转结构，强烈地按摩水柱，给您的身体带来舒适的按摩效果。

### CRATER DESIGN

The exterior design of the crater is a spiral water channel structure, like the dark and swell under the calm waves.

### 出水口设计

火山口螺旋水道的外观设计结构，如黑暗，在平静的海浪下膨胀

### VERTICAL COLUMNAR WATER

Straight hollow water design, the water flow is under pressure, and the water falling on the human body is as comfortable and relaxing as massaging the human body

### 柱状按摩水

直通水流设计，水流压力小，落水时给人体带来舒适和放松的按摩

### LIP STYLE SWITCH BUTTON

Smooth and soft, ergonomics, easy to operate, smart appearance, let you feel natural and comfortable

### 唇型切换按钮

光滑柔软，符合人体工学，易于操作，智能外观，让您感受自然舒适

### TWO WATER PIPES DESIGN

The gap between the surface of the hand shower and the hot water flowing inside is formed, and the handle is not too hot even after a long time hot water shower. Moreover, the water flow does not pass through the electroplating body, effectively avoiding water pollution caused by electroplating.

### 含内水路，防烫安全

花洒表面与内部流出的热水之间形成了缝隙，即使热水淋浴时间长了把手也不会太烫，而且水流不通过电镀体，有效避免电镀造成的水污染。

# HAND HELD SHOWER FUNCTION

手持花洒功能



## HAND HELD SHOWERS 手持花洒



**S9001**

Three functions  
Rain, Massage, Rain+massage  
Size: 120×246mm

手持花洒  
三功能  
雨淋、按摩、雨淋 + 按摩  
尺寸: 120×246mm



**S9004**

Button three functions  
Rain, Spray gun, Rain+spray gun  
Size: 113×241mm

手持花洒  
按键三功能  
雨淋、喷枪、雨淋 + 喷枪  
尺寸: 113×241mm



**S9003**

Button four functions  
Rain, Spray, Spray+rain, Descaling  
Size: 94×260mm

手持花洒  
按键四功能  
雨淋、喷雾、雨淋 + 喷雾、除垢  
尺寸: 94×260mm



**S9006**

Toggle switch three functions  
Rain, Massage, Rain+massage  
Size: 120×253mm

手持花洒  
拨柄三功能  
雨淋、按摩、雨淋 + 按摩  
尺寸: 120×253mm



**S9007**

Button three functions  
Rain, Rotating massage,  
Rain+rotating massage  
Size: 131×242mm

手持花洒  
按键三功能  
雨淋、旋转按摩、雨淋 + 旋转按摩  
尺寸: 131×242mm



**S9008**

Button three functions  
Rain, Rotating massage,  
Rain+rotating massage  
Size: 131×240mm

手持花洒  
按键三功能  
雨淋、旋转按摩、雨淋 + 旋转按摩  
尺寸: 131×240mm



**S9009**

Monofunctional  
Rain  
Size: 249×83mm

手持花洒  
单功能  
雨淋  
尺寸: 249×83mm



**S8947**

Three functions  
Rain, Massage, Rain+massage  
Size: 257×80mm

手持花洒  
三功能  
雨淋、按摩、雨淋 + 按摩  
尺寸: 257×80mm



**S8942**

Toggle switch three functions  
Rain, Massage, Rain+massage  
Size: 236×96mm

手持花洒  
拨柄三功能  
雨淋、按摩、雨淋 + 按摩  
尺寸: 236×96mm



**S8945**

Toggle switch five functions  
Descaling, Spray, Rain,  
Rain+massage massage  
Size: 250×120mm

手持花洒  
拨柄五功能  
除垢、喷雾、雨淋、雨淋 + 按摩、按摩  
尺寸: 250×120mm



**S8951**

Monofunctional  
Rain  
Size: 35×216mm

手持花洒  
单功能  
雨淋  
尺寸: 35×216mm



**S8950**

Monofunctional  
Rain  
Size: 30×190mm

手持花洒  
单功能  
雨淋  
尺寸: 30×190mm

! LIFTING 升降架



3715  
Lifting  
升降架



3717  
Lifting  
升降架



3718  
Lifting  
升降架



3719  
Lifting  
升降架

! SHOWER HOSE 花洒软管



1569  
Shower hose  
Size: 1500mm  
花洒软管  
尺寸: 1500mm



1565  
Shower hose  
Size: 1500mm  
花洒软管  
尺寸: 1500mm

! SHOWER PEDESTAL 花洒座



3704  
Shower pedestal  
花洒座



3705  
Shower pedestal  
花洒座



3707  
Shower pedestal  
花洒座



3709  
Shower pedestal  
花洒座



3710  
Shower pedestal  
花洒座



3721  
Shower pedestal  
花洒座



3722  
Shower pedestal  
花洒座



3723  
Shower pedestal  
花洒座

! CONNECTOR 转接头



3602  
Connector  
转接头



3603  
Connector  
转接头



3605  
Connector  
转接头



3606  
Connector  
转接头

! DOWN SPOUT 下出水嘴



3803  
Down spout  
下出水嘴



3804  
Down spout  
下出水嘴



3805  
Down spout  
下出水嘴



3806  
Down spout  
下出水嘴



---

# KITCHEN SYSTEM

厨房系统

---

THERE IS NO EXTRAVAGANCE AND FLAUNT, COMFORT AND NATURE ARE ENOUGH TO RELEASE, RELATIVES AND INDULGENCE. WHEN FAR AWAY FROM THE TENSION AND AMBIGUITY OF THE CITY, TRANQUILITY, AND KINDNESS IS ENOUGH TO RELAX, ENJOYMENT AND REST.





VIEW  
DESIGN





# PURIFIED



CAREFREE ENJOYMENT



**KITCHEN SYSTEM Series** 厨房系列



**DC8372**  
Kitchen faucet  
Spout Reach:  
(L)187mm / (H)225mm  
厨房龙头  
出水嘴距离: 187×225mm



**DC8568**  
Kitchen faucet  
Spout Reach:  
(L)207mm / (H)298mm  
厨房龙头  
出水嘴距离: 207×298mm



**DC8377**  
Kitchen faucet  
Spout Reach:  
(L)240mm / (H)229mm  
厨房龙头 (抽拉)  
出水嘴距离: 240×229mm



**DC8376**  
Kitchen faucet  
Spout Reach:  
(L)240mm / (H)210mm  
厨房龙头 (抽拉)  
出水嘴距离: 240×210mm



**DC2038**  
Kitchen faucet  
Spout Reach:  
(L)205mm / (H)247mm  
厨房龙头 (洗净出水)  
出水嘴距离: 205×247mm



**DC8341S**  
Kitchen faucet  
Spout Reach:  
(L)262mm / (H)342mm  
厨房龙头 (洗净出水)  
出水嘴距离: 262×342mm



**DC8580**  
Kitchen faucet  
Spout Reach:  
(L)218mm / (H)213mm  
厨房龙头 (洗净出水)  
出水嘴距离: 218×213mm



**818190101**  
Kitchen faucet  
Spout Reach:  
(L)241mm / (H)268mm  
厨房龙头 (洗净出水)  
出水嘴距离: 241×268mm



**DC8569**  
Kitchen faucet  
Spout Reach:  
(L)224mm / (H)248mm  
厨房龙头 (提拉)  
出水嘴距离: 224×248mm

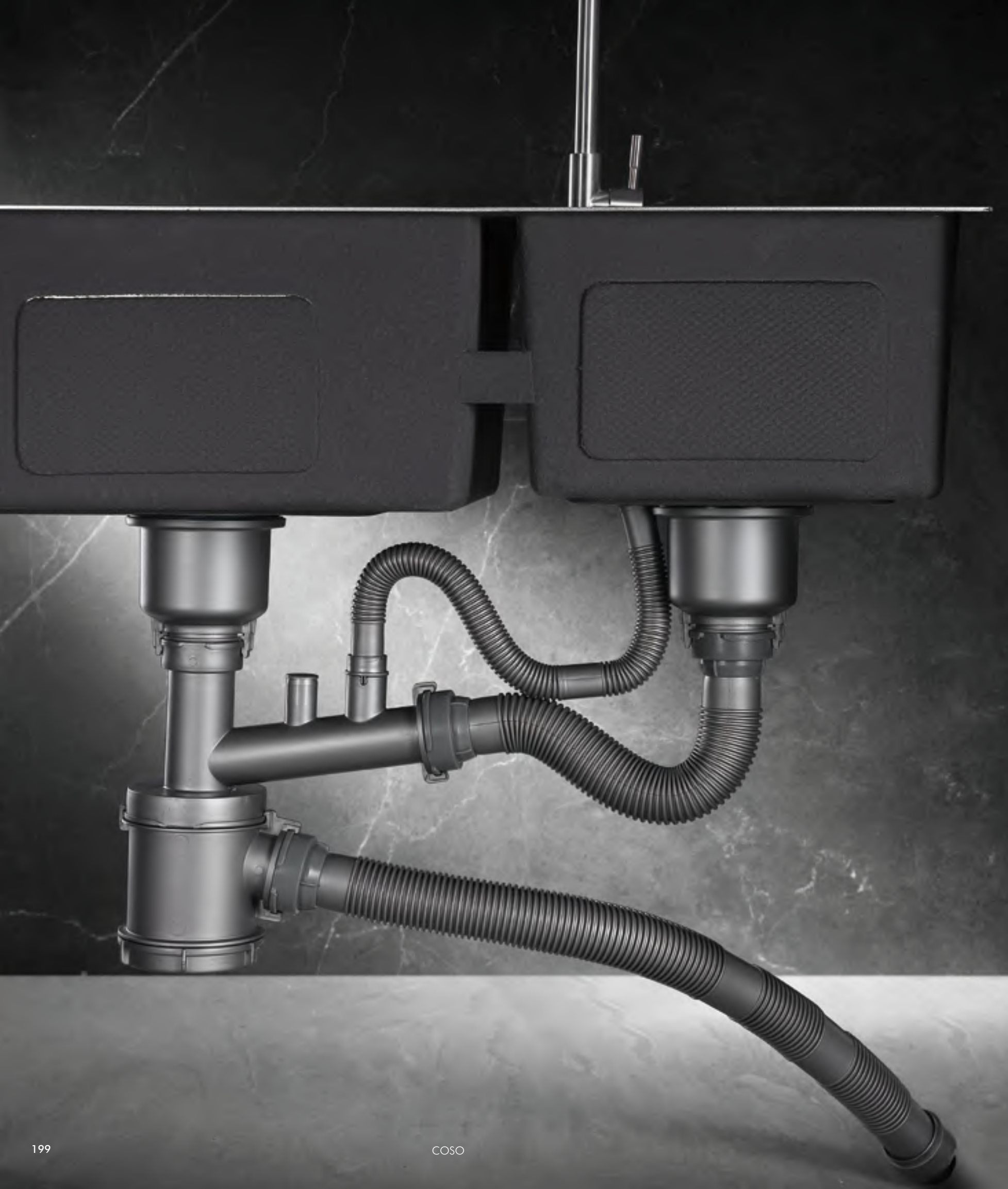

# SPOTLESS

GREATLY REDUCE THE NOISE WHEN THE RUNNING WATER HITS THE SINK, SO THAT THE KITCHEN CAN AVOID NOISE POLLUTION.



**KITCHEN SINK Series** 厨房水槽



**KITCHEN SINK Series** 厨房水槽



**UB-52150**

Material: Stainless steel  
Size: 500×420×210mm  
Surface finish: Nano  
Opening size of countertop: 470×390mm

材质: 不锈钢  
尺寸: 500×420×210mm  
表面处理: 纳米  
台面开孔尺寸: 470×390mm

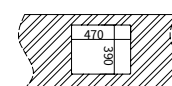

**UB-52280**

Material: Stainless steel  
Size: 800×450×210mm  
Surface finish: Nano  
Opening size of countertop: 770×420mm

材质: 不锈钢  
尺寸: 800×450×210mm  
表面处理: 纳米  
台面开孔尺寸: 770×420mm

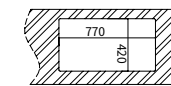

**UB-52160**

Material: Stainless steel  
Size: 600×450×210mm  
Surface finish: Nano  
Opening size of countertop: 570×420mm

材质: 不锈钢  
尺寸: 600×450×210mm  
表面处理: 纳米  
台面开孔尺寸: 570×420mm

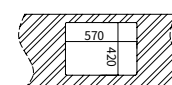

**UB-53099**

Material: Stainless steel  
Size: 680×460×220mm  
Surface finish: Stain  
Opening size of countertop: 650×430mm

材质: 不锈钢  
尺寸: 680×460×220mm  
表面处理: 拉丝  
台面开孔尺寸: 650×430mm

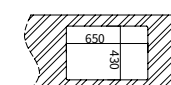

**UB-52278**

Material: Stainless steel  
Size: 780×430×210mm  
Surface finish: Nano  
Opening size of countertop: 750×400mm

材质: 不锈钢  
尺寸: 780×430×210mm  
表面处理: 纳米  
台面开孔尺寸: 750×400mm

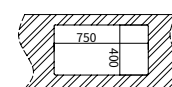

**UB-53096**

Material: Stainless steel  
Size: 800×450×220mm  
Surface finish: Stain  
Opening size of countertop: 770×420mm

材质: 不锈钢  
尺寸: 800×450×220mm  
表面处理: 拉丝  
台面开孔尺寸: 770×420mm

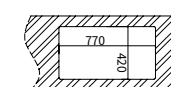



---

# HARDWARE SYSTEM

五金系统

---

ORIGINAL DESIGN OF THE COSO PRODUCTS MADE EACH PRODUCT BECAME THE BEST PRODUCT WITH PROFOUND CULTURAL BACKGROUND,IT HAS BECAME A CULTURAL SYMBOL THAT CARRIED A UNIQUE MEANING, AND EACH PRODUCT WITH WELL-DESIGNED REPRESENTS SOMETHING.A VARIETY OF DESIGN STYLES PROVIDE A SYMBOLIC CULTURE FOR THE PRODUCT, WHICH CREATES A UNIQUE SYMBOLIC WORLD FOR THEM.



Using the principle of water pressure to control the switch, subversion of the traditional faucet opening and closing mode, so that public places away from cross-infection!



# WATER PRESSURE





SOME PEOPLE BUILD NOT A HOUSE, BUT A PRIVATE RESTING PLACE. THEY DIDN'T WANT BRIGHTLY LIT STAGES, BUT RATHER LIVABLE DESIGNS. THEY ARE NOT LOOKING FOR BATHROOM PRODUCTS, BUT FOR ARCHITECTURAL TREASURES IN THE BATHROOM.

## LIVABLE DESIGNS



and meticulous design, the inside meaning  
is no longer deep,  
with the outstanding selfhood fully  
expressed.



**ACCURATE**

**FUNCTIONAL FAUCET** 功能性龙头



**AC8559**

Undercounter Basin Faucet(Pull Out)  
Spout Reach:  
(L)160mm / (H)156mm

台下盆龙头 (抽拉)  
出水嘴距离: 160×156mm



**AC2092/9001**

Undercounter Basin Faucet  
(two functions)

台下盆龙头 (2功能)



**AC2093/9001**

Undercounter Basin Faucet  
(two functions)

台下盆龙头 (2功能)



---

# TOILET SYSTEM

坐便器系列

---

SEEING YOU IN A SNOWY, WHITE, AND BRIGHT WORLD,  
TO SEE YOUR BEAUTY, TO SEE THE CHARM OF YOUR  
YOUTH, ROMANCE, AND LUXURIOUS PERSONALITY  
ARE PRESENTED EQUALLY.



WITH SPOTS AND CORNERS THAT ARE HARD TO REACH FOR CLEANING ON THE TOP OF THE INTERIOR, THE SMART TOILET ALLOWS YOU TO EXPERIENCE A WHOLE NEW LEVEL OF LUXURY, COMFORT AND CLEANLINESS.

# SMART





# WASHING

Produces a powerful flush and cleans the toilet thoroughly without any blind spots.





SMART TOILET FOR DETAIL CONTROL AND PIONEERS. ELEGANT APPEARANCE COMBINED WITH INTELLIGENT TECHNOLOGY, LEADING A NEW INTELLIGENT LIFE.



# INTELLIGENT LIFE

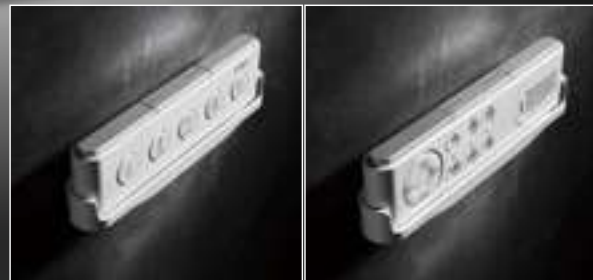

# INTELLIGENT TOILET

智能坐便器功能

## DECOMPRESSION FILTER SYSTEM

Using German technology, water flushing system forms the good water pressure, which can lengthen the service life of the machine. The water pressure is cleaner and more stable through the filter system.

净水减压过滤系统

采用德国工艺，多层过滤有效去除自来水中的细菌污物，达到净水效果，保持干净卫生；自来水通过过滤系统，冲水形成良好的水压，延长机器使用寿命。



## SUPER HYDRO-CONE TECHNOLOGY

The latest 3D super hydro-cone flushing technology is spraying the water from the depth of the toilet, the large diameter of siphon, only needs 1KG water pressure, to achieve the perfect flushing affection.

超漩虹吸式技术

最新立体超漩式虹吸冲水技术，先由坐便器边缘冲水孔喷射少量水冲污物，再吸入空气进行气压助力冲污，不仅更好的节水同时也冲洗得干干净净。



## DECOMPRESSION FILTER SYSTEM

Built-in a safety electric heating ring, with Three levels of temperature options according to your personal preference, to adjust the most suitable temperature for yourself. It is simple and convenient, more clean than the ordinary seat cotton pad.

恒温加热

内置安全加热电圈，设有五档可调节温度选项，依据您个人的喜好调节最适合的温度，简单方便，较普通坐圈棉垫更清洁卫生；



## DECOMPRESSION FILTER SYSTEM

The latest three-dimensional super vortex siphon flushing technology, first from the edge of the seat toilet flush hole spray a small amount of water to flush the dirt, and then inhale air pressure to help flush the dirt, not only better water saving but also clean.

气泡清洁

发泡式强力冲洗，将空气吸入并与注入的水流混合，水压强弱交替变化冲洗，有效促进臀部血液循环；



## DECOMPRESSION FILTER SYSTEM

Strong washing with foaming style, air inhalation and mixing it with the injected water, washing with the strong and weak alternately in the water pressure, effectively promoting the blood circulation of the buttocks;

瞬间加热器

采用韩国 3S 陶瓷瞬间加热技术，陶瓷水电完全分离模式，更省电，更安全；



## CONSTANT TEMPERATURE OF CERAMIC +ALLOY ABS HEAT

Using German technology, water flushing system forms the good water pressure, which can lengthen the service life of the machine. The water pressure is cleaner and more stable through the filter system.

恒温加陶瓷 + 合金 ABS 热

陶瓷内胆，外壳采用了合金 ABS 材料更加轻便，一个人可轻松搬运，结构坚固耐用，完全能承受一吨的重量；



## DEODORISATION SYSTEM

The working principle of high-tech automatic accelerant deodorization device is that the stink is filtered through the accelerant deodorization technology, and the air in the toilet is kept fresh and odorless at anytime.

除臭系统

高科技触媒自动除臭装置，是臭气经过触媒过滤，无论何时都保持卫生间的空气清新无异味；



## WARM DRY

Intelligent warm air drying is made your buttocks refreshing and healthy. While starting the automatic flushing system, the buttocks are more refreshing after cleaning, keeping a beautiful mood after toilet.

暖风烘干

智能暖风烘干，使您的臀部清爽健康，同时启动自动冲水，特点：清洗后臀部更加清爽，保持如厕后美丽心情；



## MICROWAVE INDUCTION TECHNOLOGY

Accurating the identification of targets through the advanced microwave induction technology, the automatic induction of the switch cover is more accurate, at anytime before you step.

微波感应技术

通过先进的微波感应技术，精确识别目标，自动开闭盖感应更加精确，随时先您一步；



## BILATERAL DAMPER SYSTEM

The double side damping system can better control the lid to turn over smoothly, buffer the fall, effectively reduce the wear of the motor, increase the service life, and achieve a stable working state.

双侧阻尼系统

采用双侧阻尼系统，更好地控制盖子平稳翻起，缓冲下落，有效减少电机的磨损，增加使用寿命，达到一个稳定的工作状态。



# ICON GUIDE

智能坐便器 - 图标功能指南

- |                                 |                                      |                                     |
|---------------------------------|--------------------------------------|-------------------------------------|
| HIP CLEANING<br>臀部清洗            | SPOUT POSITION REGULATION<br>喷嘴位置调节  | ROTARY SWITCHES<br>旋钮开关             |
| FEMALE CLEANING<br>女士专用清洗       | WATER TEMPERATURE REGULATION<br>水温调节 | BLACKOUT FLUSH<br>停电冲水              |
| WARM DRY<br>暖风烘干                | WATER PRESSURE REGULATION<br>水压调节    | NANOMETER ANTIBACTERIAL<br>纳米抗菌     |
| SEATING HEATING<br>坐圈加热         | AUTO-FLUSHING<br>自动冲水                | UV STERILIZATION<br>紫外杀菌            |
| DAMPING SLOW DESCENT<br>阻尼缓降    | AUTO FLIP UP<br>自动翻盖                 | SOFT LIGHTING<br>柔光照明               |
| SMART REMOTE CONTROLLER<br>智能遥控 | AUTO-DEODORIZATION<br>自动除臭           | FLIP COVER UP BY FOOT FLUSH<br>脚触翻盖 |
| STRONG/WEAK MASSAGE<br>强弱按摩     | MEMORY MODE<br>记忆模式                  | NOZZLE SELF-CLEANING<br>喷嘴自洁        |
| COLD/HOT MASSAGE<br>冷热清洗        | FLUSHING BY FOOT FLUSH<br>脚触冲水       | WATER PURIFICATION<br>水质净化          |

## INTELLIGENT TOILET *Seria* 智能坐便器



### TC-38818

Intelligent toilet  
Material: ceramic  
Size: 685×400×470mm  
Drainage mode: Underneath Drainage  
Toilet rough-in: 300mm/400mm

智能坐便器  
材质: 陶瓷  
尺寸: 685×400×470mm  
排水方式: 地排式  
坑距: 300mm/400mm



### TC-38811

Intelligent toilet  
Material: ceramic  
Size: 683×414×531mm  
Drainage mode: Underneath Drainage  
Toilet rough-in: 300mm

智能坐便器  
材质: 陶瓷  
尺寸: 683×414×531mm  
排水方式: 地排式  
坑距: 300mm



### TC-38819

Intelligent toilet  
Material: ceramic  
Size: 685×400×470mm  
Drainage mode: Underneath Drainage  
Toilet rough-in: 300mm/400mm

智能坐便器  
材质: 陶瓷  
尺寸: 685×400×470mm  
排水方式: 地排式  
坑距: 300mm/400mm



### TC-38820

Intelligent toilet  
Material: ceramic  
Size: 687×387×473mm  
Drainage mode: Underneath Drainage  
Toilet rough-in: 300mm/400mm

智能坐便器  
材质: 陶瓷  
尺寸: 687×387×473mm  
排水方式: 地排式  
坑距: 300mm/400mm



### TC-2081A

Intelligent toilet  
Material: ceramic  
Size: 687×395×473mm  
Drainage mode: Underneath Drainage  
Toilet rough-in: 300mm

智能坐便器  
材质: 陶瓷  
尺寸: 687×395×473mm  
排水方式: 地排式  
坑距: 300mm



### TC-2801

Intelligent toilet  
Material: ceramic  
Size: 683×406×527mm  
Drainage mode: Underneath Drainage  
Toilet rough-in: 300mm

智能坐便器  
材质: 陶瓷  
尺寸: 683×406×527mm  
排水方式: 地排式  
坑距: 300mm





# INTELLIGENT

## WALL-MOUNTED TOILET

智能挂墙坐便器功能



### INDUCTION FLIP

Built-in microwave induction module, identify the user's approach, automatically open the cover for users to use.  
Usage scenario: Users go to the toilet

Flip and turn with the remote control hanging on the wall (the button is located above the remote control, which is also convenient to use when hanging on the wall)  
Use scenario: a men urinate

Damping slow down: after detecting the user's departure, the seat cover seat ring will be automatically closed, and the seat cover seat ring will fall slowly, no longer worrying about the annoying noise affecting the family.

#### 感应翻盖

内置微波感应模块，识别用户靠近，自动打开坐盖便于用户使用。  
使用场景：用户如厕

使用挂在墙上的遥控器实现翻盖翻圈（按键位于遥控器上方，挂在墙上也能很方便的使用）  
使用场景：男士小便

阻尼缓降：检测到用户离开后，自动关闭坐盖坐圈，坐盖坐圈缓慢降落，不再担心恼人的噪音影响到家人。



### ULTRAVIOLET WATER STERILIZATION

Urban tap water through the pipeline inevitably bacteria breeding, for the dynamic killing of bacteria and other microorganisms in the flow of water, cleaning the user's private part of the water into the machine will be ultraviolet light, to ensure that users in the cleaning of the water is clean and assured.

#### 紫外水杀菌

城市的自来水经过管道难免有细菌滋生，针对流动水流中细菌等微生物的动态灭杀，清洗用户私处的水进入机器便进行紫外线的灯光，保障用户在清洗时的水都是干净放心的。



### DETACHABLE NOZZLE

The new upgraded 3D arc stainless steel spray rod can not only effectively prevent fouling, but also improve the cleaning Angle, provide a wider cleaning area and cleaning comfort. Convenient detachable ingenious nozzle design, convenient for daily toilet cleaning and regular replacement, to solve the problem of scale blockage.

#### 可拆卸喷头

全新升级的 3D 弧形不锈钢材质喷杆，在有效防止挂污的同时，可改善清洗角度，提供更广的清洗面积及清洗舒适度。  
方便快捷的巧妙喷头设计，方便日常如厕清洁及定期更换，解决水垢堵塞问题。



### STRONG WARM AIR DRYING

By improving the performance of the drying device to improve the drying efficiency ordinary drying time reduced by 50%, and improve the use experience, really solve the pain point of users.

#### 强力暖风烘干

通过改善烘干装置的性能来提高烘干效率，普通烘干减少 50% 的烘干用时，并提升使用体验，真正解决用户痛点。



### NOZZLE STERILIZATION

280nm wavelength, effectively remove bacteria and dirt, escherichia coli, staphylococcus aureus, candida albicans elimination rate up to 99%, to avoid cross infection, give meticulous care to family.

#### 喷头杀菌

280nm 波长，有效清除细菌及污物，大肠杆菌、金黄色葡萄球菌、白色念珠菌消杀率高达 99%，避免交叉感染，给予家人细致入微的呵护。



### ANTIBACTERIAL SEAT

Adopting silver ion antibacterial material certified by SIAA international authority, it has remarkable antibacterial and bacteriostatic effect and keeps the seat ring clean for a long time.

#### 抗菌坐圈

采用 SIAA 国际权威认证银离子抗菌材料，具有显著的抗菌、抑菌功效，长久保持坐圈洁净。



### MULTI-FUNCTION CLEANING

Buttock wash, woman wash, reciprocating cleaning, nozzle self cleaning, cold and hot massage. A variety of different cleaning modes are available to meet the needs of the whole family.

#### 多功能清洗

臀洗、妇洗、往复清洗、喷嘴自洁、冷热按摩。  
多种不同清洗模式可供选择，满足全家人的使用需求。



### SEAT HEATING

Sitting down is comfortable and reassuring, with built-in sensors that can detect the state of sitting down in time, and when you sit down, you will be surrounded by the warmth of the toilet. Adaptive seat temperature adjustment and sensing skin temperature, prevent low temperature scald.

#### 坐圈加热

落坐舒适安心，内置传感器能够及时检测落坐状态，每当你落坐时，都会被坐便器的温暖包围。自适应坐温调节并感知皮肤温度，防止低温烫伤。



### AUTOMATIC DEODORIZATION

After the user sits on the seat, the deodorizer automatically opens, and the built-in activated carbon absorbs the odor, and then catalyzes the decomposition of the odor through the catalyst on the surface. No replacement, no maintenance costs, Durable and efficient, do not worry about time and effect attenuation.

#### 自动除臭

用户着坐后，除臭风机自动开启，内置活性炭对异味进行吸附，再通过表面的触媒对异味进行催化分解。  
无需更换，没有任何维护成本；持久高效，不用担心时间久而效果衰减。



### FLUSH MODE

Automatic flushing from the seat: the machine will realize automatic flushing function after the user leaves the seat for 6s after going to the toilet

[Because the machine and water tank are separated, many competing products do not have this function]

Dry flushing: Because dirt will fall into the water during the cleaning process, odor will be emitted after drying, so when using intelligent cleaning (namely cleaning + flushing + drying), when the cleaning is finished, warm air drying will be automatically flushed.

Size flushing: intelligent identification of size flushing: when a woman goes to the toilet, it will automatically determine the size of flushing; Manual control: When a man urinates, he can achieve the size flushing function through the panel mounted on the wall.

#### 冲水模式

**离坐自动冲水：**离坐自动冲水用户如厕完毕离坐 6s 后，机器会实现自动冲水功能（因机器和水箱是分开的，故很多竞品无此功能）

**干燥冲水：**因清洗的过程中脏污会掉落在水中，烘干开启后会导致臭气散发，故使用智能清洗时（即清洗 + 冲水 + 烘干），当清洗完毕，开始暖风烘干的同时会自动进行一次冲水。

**智能识别大小冲：**女士如厕时，会自动判断实现大小冲；

**手动控制：**男士小便时，可以通过安装在墙上的面板实现大小冲功能。



WHEN YOU CAME,  
I OPENED IT

INTELLIGENT WALL-MOUNTED TOILET *Series* 智能挂墙坐便器系列



**TC-1552**

Concealed flush tank  
Size: 500×1120×72mm  
Installation: Concealed  
Wall-hung toilet  
Note: standard FP-1006

暗装水箱  
水箱尺寸: 500×1120×72mm  
安装方式: 入墙暗装式  
适配: 智能挂墙坐便器  
注: 标配 FP-1006



**TC-38880**

Intelligent wall-mounted toilet  
Material: ceramic  
Size: 612×396×338mm  
Drainage mode: Rear Drainage  
Mounting hole distance: 180mm

智能挂墙坐便器  
材质: 陶瓷  
尺寸: 612×396×338mm  
排水方式: 墙排式  
安装孔距: 180mm



**FP-1006**

Toilet flush plates  
暗装水箱面板



**HANGING WALL TOILET** *Serius* 挂墙坐便器系列



**TC-38903**

Hanging wall toilet  
Material: ceramic  
Size: 560×365×350mm  
Drainage mode: Rear Drainage  
Mounting hole distance: 180mm

挂墙坐便器  
材质: 陶瓷  
尺寸: 560×365×350mm  
排水方式: 墙排式  
安装孔距: 180mm



**TC-38907**

Hanging wall toilet  
Material: ceramic  
Size: 535×360×360mm  
Drainage mode: Rear Drainage  
Mounting hole distance: 180mm

挂墙坐便器  
材质: 陶瓷  
尺寸: 535×360×360mm  
排水方式: 墙排式  
安装孔距: 180mm



**TC-38905**

Hanging wall toilet  
Material: ceramic  
Size: 535×360×360mm  
Drainage mode: Rear Drainage  
Mounting hole distance: 180mm

挂墙坐便器  
材质: 陶瓷  
尺寸: 535×360×360mm  
排水方式: 墙排式  
安装孔距: 180mm



**TC-1550**

Concealed flush tank  
Size: 590×80×1140mm  
Installation: Concealed  
Note: standard FP-1004  
optional FP-1003/FP-1005

暗装水箱  
水箱尺寸: 590×80×1140mm  
安装方式: 入墙暗装式  
适配: 壁挂坐便器  
注: 标配 FP-1004  
选配 FP-1003/FP-1005



**FP-1003**

Toilet flush plates  
暗装水箱面板



**FP-1004**

Toilet flush plates  
暗装水箱面板



**FP-1005**

Toilet flush plates  
暗装水箱面板



**FLOOR-STANDING TOILET** *Series* 落地式坐便器系列



**TC-38902**

Floor-standing toilet  
Material: ceramic  
Size: 560×355×405mm  
Drainage mode: Rear Drainage  
Toilet rough-in: 180mm

落地式坐便器  
材质: 陶瓷  
尺寸: 560×355×405mm  
排水方式: 墙排式  
坑距: 180mm



**TC-38901**

Floor-standing toilet  
Material: ceramic  
Size: 565×355×400mm  
Drainage mode: Rear Drainage  
Toilet rough-in: 180mm

落地式坐便器  
材质: 陶瓷  
尺寸: 565×355×400mm  
排水方式: 墙排式  
坑距: 180mm



**TC-1549**

Concealed flush tank  
Size: 551×80×1127mm  
Installation: Concealed  
Squatting pan/ Floor-standing toilet  
Note: standard FP-1004  
optional FP-1003/FP-1005

暗装水箱  
水箱尺寸: 551×80×1127mm  
安装方式: 入墙暗装式  
适配: 蹲便器 / 落地坐便器  
注: 标配 FP-1004  
选配 FP-1003/FP-1005



**FP-1003**

Toilet flush plates  
暗装水箱面板



**FP-1004**

Toilet flush plates  
暗装水箱面板



**FP-1005**

Toilet flush plates  
暗装水箱面板

# TOILET FUNCTION

坐便器功能

## 360°FLUSHING SYSTEM

The latest launch of the double-hole washer toilet is flushing by the double holes at the same time, produce a strong double spiral vortex flow instantly. 360° flushing can cover the silent when flushing the edges of the inner wall, turbulent erosion force, overturning the previous way of flushing. There is no hiding place for dirt and too achieve a qualitative leap.

### 360°超漩冲刷

最新推出双孔洗刷坐便，双孔同时冲水，瞬间产生强大双螺旋漩涡水流，漩涡式水流360°覆盖静音冲刷无死角，汹涌的冲刷力，颠覆以往冲水方式。让污垢无处藏身，实现“质”的飞跃。



## NANO SELF-CLEANING GLAZE

The double protections of ultra smooth surface and the ion isolation eliminate the dirt that contains in the gap. Eliminating the possibilities of fouling adhesion and bacterial survival thoroughly, clean and convenient, durable anti fouling and bacteria control.

### 纳米自洁釉面

超平滑表面与离子隔离的双重保护，摒除容纳污垢的空隙。彻底杜绝污垢黏附和细菌生存的可能，清洁更方便，持久抗污防菌。



## STRONG INSTANT DRAIN PIPE

The double protections of ultra smooth surface and the ion isolation eliminate the dirt that contains in the gap. Eliminating the possibilities of fouling adhesion and bacterial survival thoroughly, clean and convenient, durable anti fouling and bacteria control.

### 瞬间强排管道

坐便器均采用优化管道内施釉技术，排污管直径最大达60mm，加大瞬间强排，强劲排污力度，一次冲净。



## SLOW DOWN THE COVER PLATE

Equipped with high quality toilet seat cover, and it is convenient to disassemble and assemble, and has the function of slowdown. The application of urea formaldehyde material makes the high surface gloss, not easy to fade, high hardness, not easy to scratch.

### 静音缓降盖板

配套高质感坐便盖板，便捷拆装，缓降功能。其脲醛材质的运用令表面光泽度高，不易褪色，硬度高，不易刮损。



## DOUBLE LEVELS OF ENVIRONMENTAL PROTECTION AND WATER SAVING

The traditional 3L/6L toilet is upgraded to the 3L/4.8L of the super water saving toilet, and the drain valve is increased to 3 inches. Its flushing speed is increased upto 2.0-2.8L/s, is higher than the 2 inches drain valve, which only has 1.7L/s. This design allows the water to flow quickly over the waterway, which results in a strong siphon effect.

### 双档环保节水

将传统的3L/6L坐便器升级为3L/4.8L超节水型坐便器的排水阀加大到3寸。令冲水速度高达2.0-2.8L/s，高于2寸排水阀1.7L/s的国家标准，这样的设计能让水快速流满水路，从而产生强劲的喷射虹吸效果。



## FIVE-STAR OF HIGH QUALITY WATER FITTINGS

Supported by a high standard water system, innovative structural design, unparalleled product quality, excellent system performance, each design has gone through 250,000 limit tests, no water leaking.

### 五星优质水件

配套高规格的水件系统，其革新的结构设计，无与伦比的产品质量，卓越的系统性能，每一款设计都经过25万次极限测试，冲水无滴漏。



## SINGLE HOLE OF INDEPENDENT POLLUTION DISCHARGE

More close to the design of human nature, uniform and solid wall, no gap inside. Eliminate microleakage in the process of use, clean and hygienic.

### 单孔独立排污

更贴近人性的设计，管壁均匀结实，内部无缝隙。杜绝使用过程中出现的微渗漏，洁净卫生。



TOILET *Series* 坐便器系列



**TC-38666**

Toilet  
Material: ceramic  
Size: 710×380×760mm  
Drainage mode: Underneath Drainage  
Toilet rough-in: 300mm/400mm

坐便器  
材质: 陶瓷  
尺寸: 710×380×760mm  
排水方式: 地排式  
坑距: 300mm/400mm



**TC-38669**

Toilet  
Material: ceramic  
Size: 690×370×730mm  
Drainage mode: Underneath Drainage  
Toilet rough-in: 300mm/400mm

坐便器  
材质: 陶瓷  
尺寸: 690×370×730mm  
排水方式: 地排式  
坑距: 300mm/400mm



**TC-38728**

Toilet  
Material: ceramic  
Size: 710×375×765mm  
Drainage mode: Underneath Drainage  
Toilet rough-in: 300mm/400mm

坐便器  
材质: 陶瓷  
尺寸: 710×375×765mm  
排水方式: 地排式  
坑距: 300mm/400mm



**TC-38713**

Toilet  
Material: ceramic  
Size: 725×400×665mm  
Drainage mode: Underneath Drainage  
Toilet rough-in: 300mm/400mm

坐便器  
材质: 陶瓷  
尺寸: 725×400×665mm  
排水方式: 地排式  
坑距: 300mm/400mm



**TC-38715**

Toilet  
Material: ceramic  
Size: 675×365×720mm  
Drainage mode: Underneath Drainage  
Toilet rough-in: 300mm/400mm

坐便器  
材质: 陶瓷  
尺寸: 675×365×720mm  
排水方式: 地排式  
坑距: 300mm/400mm



**TC-38720**

Toilet  
Material: ceramic  
Size: 720×460×610mm  
Drainage mode: Underneath Drainage  
Toilet rough-in: 300mm/400mm

坐便器  
材质: 陶瓷  
尺寸: 720×460×610mm  
排水方式: 地排式  
坑距: 300mm/400mm



**TC-38667**

Toilet  
Material: ceramic  
Size: 600×400×660mm  
Drainage mode: Underneath Drainage  
Toilet rough-in: 300mm/400mm

坐便器  
材质: 陶瓷  
尺寸: 600×400×660mm  
排水方式: 地排式  
坑距: 300mm/400mm



**TC-38702**

Toilet  
Material: ceramic  
Size: 710×370×690mm  
Drainage mode: Underneath Drainage  
Toilet rough-in: 300mm/400mm

坐便器  
材质: 陶瓷  
尺寸: 710×370×690mm  
排水方式: 地排式  
坑距: 300mm/400mm



**TC-38661**

Toilet  
Material: ceramic  
Size: 750×390×775mm  
Drainage mode: Underneath Drainage  
Toilet rough-in: 300mm/400mm

坐便器  
材质: 陶瓷  
尺寸: 750×390×775mm  
排水方式: 地排式  
坑距: 300mm/400mm



**TC-38726**

Toilet  
Material: ceramic  
Size: 720×450×750mm  
Drainage mode: Underneath Drainage  
Toilet rough-in: 300mm

坐便器  
材质: 陶瓷  
尺寸: 720×450×750mm  
排水方式: 地排式  
坑距: 300mm



For details and pioneers. Elegant appearance fusion of intelligent technology, leading a new

INTELLIGENT LIFE

DETAILS  
PIONEERS





TOILET *Seria* 坐便器系列



TC-38730

Toilet  
 Material: ceramic  
 Size: 750×390×775mm  
 Drainage mode: Underneath Drainage  
 Toilet rough-in: 300mm/400mm

坐便器  
 材质: 陶瓷  
 尺寸: 750×390×775mm  
 排水方式: 地排式  
 坑距: 300mm/400mm



TC-38906

Hanging wall toilet  
 Material: ceramic  
 Drainage mode: Rear Drainage  
 Mounting hole distance: 180mm

挂墙坐便器  
 材质: 陶瓷  
 排水方式: 墙排式  
 安装孔距: 180mm



TC-1556

Concealed flush tank  
 Installation: Concealed  
 Adaptation: Wall-mounted toilet  
 Water tank size: 580×92×1150mm  
 Note: Standard FP-1007

暗装水箱  
 安装方式: 入墙暗装式  
 适配: 壁挂坐便器  
 水箱尺寸: 580×92×1150mm  
 注: 标配 FP-1007



FP-1007

Toilet flush plates  
 暗装水箱面板





---

# BASIN SERIES

台盆系列

---

WE MAKE THE MOST DEMANDING TABLE BASINS IN TERMS OF MATERIAL, SHAPE AND FUNCTION. WE PRODUCE PRODUCTS THAT MEET THE BASIC NEEDS OF CLEANLINESS AND AESTHETICS, WHILE BLENDING INTO DIFFERENT LIVING ENVIRONMENTS. MINIMALIST FASHION DESIGN, GERMAN MADE HANDICRAFT CHAMPION.



## SIMPLICITY AND ELEGANCE IN STYLE



LET THE SOUL NO LONGER SLEEP,  
UNTIE THE HEAVY SHACKLE. LET THE LIFE PUT  
ON AN ENTIRELY NEW LOOK, NATURE BATH,  
A FRESH LIFE IS BEGINNING.



**COUNTERTOP WASHBASIN** *Series* 台上盆系列



**TC-32663**  
 Countertop washbasin  
 Color: Black + white  
 Size: 500×400×135mm  
 台上盆  
 颜色: 黑色 + 白色  
 尺寸: 500×400×135mm



**TC-32665**  
 Countertop washbasin  
 Color: White + black edge  
 Size: 600×350×110mm  
 台上盆  
 颜色: 白色 + 黑边  
 尺寸: 600×350×110mm



**TC-32661**  
 Countertop washbasin  
 Color: Black  
 Size: 500×400×135mm  
 台上盆  
 颜色: 黑色  
 尺寸: 500×400×135mm



**TC-32662**  
 Countertop washbasin  
 Color: Black + white  
 Size: 420×420×135mm  
 台上盆  
 颜色: 黑色 + 白色  
 尺寸: 420×420×135mm



**TC-32660**  
 Countertop washbasin  
 Color: Black  
 Size: 420×420×135mm  
 台上盆  
 颜色: 黑色  
 尺寸: 420×420×135mm



**TC-32687**  
 Countertop washbasin  
 Color: White  
 Size: 430×430×130mm  
 台上盆  
 颜色: 白色  
 尺寸: 430×430×130mm

! COUNTERTOP WASHBASIN *Serius* 台上盆系列



TC-32631

Countertop washbasin  
Color: White  
Size: 405×405×140mm

台上盆  
颜色: 白色  
尺寸: 405×405×140mm



TC-32632

Countertop washbasin  
Color: White  
Size: 390×390×150mm

台上盆  
颜色: 白色  
尺寸: 390×390×150mm



TC-32633

Countertop washbasin  
Color: White  
Size: 495×395×150mm

台上盆  
颜色: 白色  
尺寸: 495×395×150mm



TC-32635

Countertop washbasin  
Color: White  
Size: 605×425×150mm

台上盆  
颜色: 白色  
尺寸: 605×425×150mm



TC-32636

Countertop washbasin  
Color: White  
Size: 510×390×150mm

台上盆  
颜色: 白色  
尺寸: 510×390×150mm

! SEMI-INSET WASHBASIN *Serius* 台中盆系列



TC-32699

Semi-inset washbasin  
Color: Black  
Size: 570×400×160mm

台中盆  
颜色: 黑色  
尺寸: 570×400×160mm



TC-32698

Semi-inset washbasin  
Color: White  
Size: 585×420×175mm

台中盆  
颜色: 白色  
尺寸: 585×420×175mm



TC-32697

Semi-inset washbasin  
Color: White  
Size: 590×470×170mm

台中盆  
颜色: 白色  
尺寸: 590×470×170mm



TC-32696

Semi-inset washbasin  
Color: White  
Size: 595×380×130mm

台中盆  
颜色: 白色  
尺寸: 595×380×130mm

UNDERCOUNTER WASHBASIN *Series* 台下盆系列



**TC-32611**

Undercounter washbasin  
Color: White  
Size: 530×345×185mm

台下盆  
颜色: 白色  
尺寸: 530×345×185mm



**TC-32691**

Undercounter washbasin  
Color: White  
Size: 530×375×200mm

台下盆  
颜色: 白色  
尺寸: 530×375×200mm



**TC-32688**

Undercounter washbasin  
Color: White  
Size: 500×395×180mm

台下盆  
颜色: 白色  
尺寸: 500×395×180mm



**TC-32612**

Undercounter washbasin  
Color: White  
Size: 500×415×190mm

台下盆  
颜色: 白色  
尺寸: 500×415×190mm



**TC-32700**

Undercounter washbasin  
Color: White  
Size: 560×410×195mm

台下盆  
颜色: 白色  
尺寸: 560×410×195mm



**TC-32615**

Undercounter washbasin  
Color: White  
Size: 560×430×200mm

台下盆  
颜色: 白色  
尺寸: 560×430×200mm



**TC-32702**

Undercounter washbasin  
Color: White  
Size: 560×380×185mm

台下盆  
颜色: 白色  
尺寸: 560×380×185mm



**TC-32692**

Undercounter washbasin  
Color: White  
Size: 595×395×200mm

台下盆  
颜色: 白色  
尺寸: 595×395×200mm



**TC-32653**

Undercounter washbasin  
Color: White  
Size: 600×410×205mm

台下盆  
颜色: 白色  
尺寸: 600×410×205mm



**TC-32655**

Undercounter washbasin  
Color: White  
Size: 610×410×195mm

台下盆  
颜色: 白色  
尺寸: 610×410×195mm



**TC-32701**

Undercounter washbasin  
Color: White  
Size: 610×435×215mm

台下盆  
颜色: 白色  
尺寸: 610×435×215mm



**TC-32695**

Undercounter washbasin  
Color: White  
Size: 740×420×190mm

台下盆  
颜色: 白色  
尺寸: 740×420×190mm

UNDERCOUNTER WASHBASIN *Series* 台下盆系列



---

# BATHTUB SERIES

浴缸系列

---

IMMERSE YOURSELF IN A WORLD OF POSSIBILITIES AND SENSATIONS WITH THE COSO BATHTUB. CLASSIC YET MODERN SHAPES AND STATE-OF-THE-ART MATERIALS ADD AN EXTRA SENSORY DIMENSION AND OFFER AN INNOVATIVE EDGE IN QUALITY, DURABILITY AND APPEARANCE.



BY-1822

Installation: Freestanding  
 Material: Acrylic  
 Color: Bright white  
 Size: 1200×650×580mm  
       : 1300×700×580mm  
       : 1350×700×580mm  
       : 1400×700×580mm  
       : 1500×750×580mm  
       : 1600×750×580mm  
       : 1700×800×580mm  
       : 1800×800×580mm

安装方式: 搁置式  
 材质: 亚克力  
 颜色: 亮光白  
 尺寸: 1200×650×580mm  
       : 1300×700×580mm  
       : 1350×700×580mm  
       : 1400×700×580mm  
       : 1500×750×580mm  
       : 1600×750×580mm  
       : 1700×800×580mm  
       : 1800×800×580mm

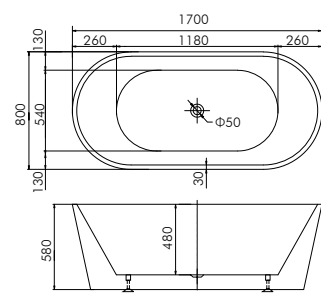

BY-1825

Installation: Freestanding  
 Material: Acrylic  
 Color: Bright white  
 Size: 1500×800×780mm  
       : 1680×800×780mm  
       : 1800×850×800mm

安装方式: 搁置式  
 材质: 亚克力  
 颜色: 亮光白  
 尺寸: 1500×800×780mm  
       : 1680×800×780mm  
       : 1800×850×800mm

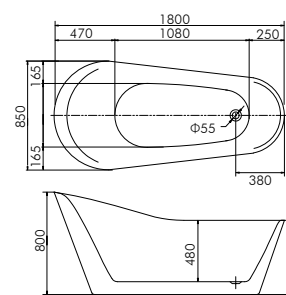



BY-1826

Installation: Freestanding  
 Material: Acrylic  
 Color: Bright white  
 Size: 1700×800×710mm  
 : 1800×900×690mm

安装方式: 搁置式  
 材质: 亚克力  
 颜色: 亮光白  
 尺寸: 1700×800×710mm  
 : 1800×900×690mm

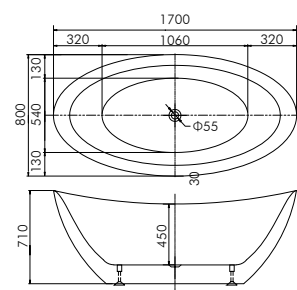

BY-1827

Installation: Freestanding  
 Material: Acrylic  
 Color: Bright white  
 Size: 1500×800×800mm  
 : 1700×800×820mm  
 : 1800×900×760mm

安装方式: 搁置式  
 材质: 亚克力  
 颜色: 亮光白  
 尺寸: 1500×800×800mm  
 : 1700×800×820mm  
 : 1800×900×760mm

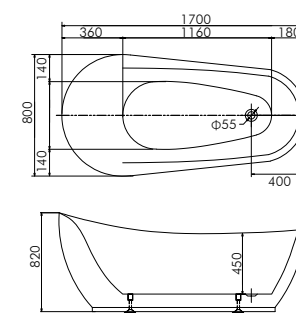





BY-1846A

Installation: Freestanding  
 Material: Acrylic  
 Color: Matte white  
 Size: 1600×800×580mm  
 : 1700×800×580mm

安装方式: 搁置式  
 材质: 亚克力  
 颜色: 哑光白  
 尺寸: 1600×800×580mm  
 : 1700×800×580mm

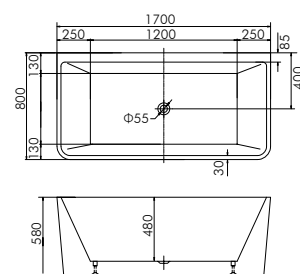

BY-1851

Installation: Freestanding  
 Material: Acrylic  
 Color: Matte white  
 Size: 1400×750×580mm  
 : 1500×750×580mm  
 : 1600×800×580mm  
 : 1700×800×580mm  
 : 1800×800×580mm

安装方式: 搁置式  
 材质: 亚克力  
 颜色: 哑光白  
 尺寸: 1400×750×580mm  
 : 1500×750×580mm  
 : 1600×800×580mm  
 : 1700×800×580mm  
 : 1800×800×580mm

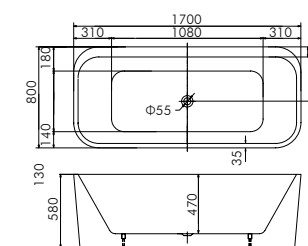



BY-1847

Installation: Freestanding  
 Material: Acrylic  
 Color: Matte black and white  
 Size: 1500×750×620mm  
       : 1700×800×620mm

安装方式: 搁置式  
 材质: 亚克力  
 颜色: 哑光黑白  
 尺寸: 1500×750×620mm  
       : 1700×800×620mm

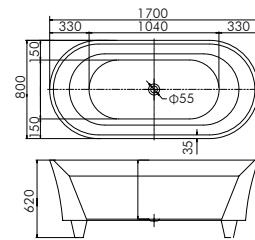

BY-1833

Installation: Freestanding  
 Material: Acrylic  
 Color: Bright white  
 Size: 1750×850×580mm  
 Note: with handrail

安装方式: 搁置式  
 材质: 亚克力  
 颜色: 亮光白  
 尺寸: 1750×850×580mm  
 注: 配扶手

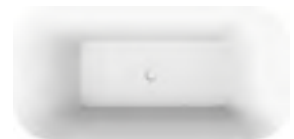
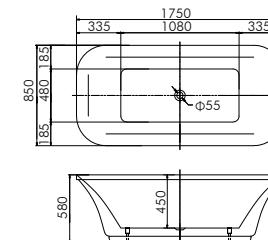



BY-1852

Installation: Freestanding  
 Material: Acrylic  
 Color: Matte white  
 Size: 1300×700×580mm  
       : 1400×750×580mm  
       : 1500×750×580mm  
       : 1600×750×580mm  
       : 1700×830×580mm

安装方式: 搁置式  
 材质: 亚克力  
 颜色: 哑光白  
 尺寸: 1300×700×580mm  
       : 1400×750×580mm  
       : 1500×750×580mm  
       : 1600×750×580mm  
       : 1700×830×580mm

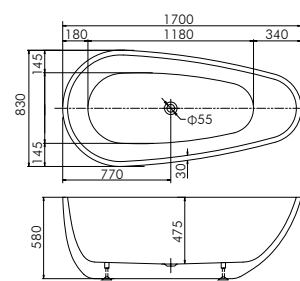

BY-1853

Installation: Freestanding  
 Material: Acrylic  
 Color: Matte white  
 Size: 1700×800×580mm

安装方式: 搁置式  
 材质: 亚克力  
 颜色: 哑光白  
 尺寸: 1700×800×580mm

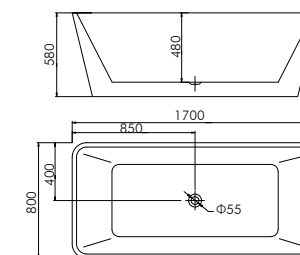



BY-1857

Installation: Freestanding  
Material: Acrylic  
Color: Bright white  
Size: 1800×800×580mm

安装方式: 搁置式  
材质: 亚克力  
颜色: 亮光白  
尺寸: 1800×800×580mm

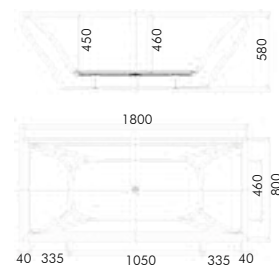

BY-1850

Installation: Freestanding  
Material: Artificial stone  
Color: Matte white  
Size: 1790×795×560mm

安装方式: 搁置式  
材质: 精铝制石  
颜色: 哑光白  
尺寸: 1790×795×560mm

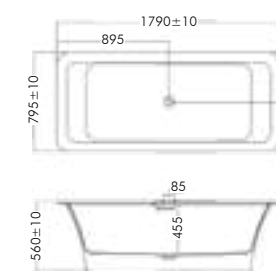



BY-1823

Installation: Freestanding  
 Material: Acrylic  
 Color: Bright white  
 Size: 1100×700×560mm  
 : 1200×700×560mm  
 : 1300×700×580mm  
 : 1400×700×580mm  
 : 1500×750×580mm  
 : 1600×750×580mm  
 : 1700×800×580mm

安装方式: 搁置式  
 材质: 亚克力  
 颜色: 亮光白  
 尺寸: 1100×700×560mm  
 : 1200×700×560mm  
 : 1300×700×580mm  
 : 1400×700×580mm  
 : 1500×750×580mm  
 : 1600×750×580mm  
 : 1700×800×580mm

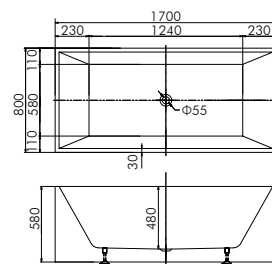

BY-1832

Installation: Freestanding  
 Material: Acrylic  
 Color: Bright white  
 Size: 1350×1350×600mm  
 : 1500×1500×630mm

安装方式: 搁置式  
 材质: 亚克力  
 颜色: 亮光白  
 尺寸: 1350×1350×600mm  
 : 1500×1500×630mm





BY-1845A

Installation: Freestanding  
 Material: Acrylic  
 Color: Matte white  
 Size:  $\Phi 1100 \times 600$ mm

安装方式: 搁置式  
 材质: 亚克力  
 颜色: 哑光白  
 尺寸:  $\Phi 1100 \times 600$ mm

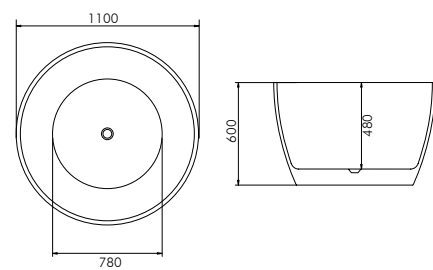

BY-1845

Installation: Freestanding  
 Material: Acrylic  
 Color: Matte black and white  
 Size:  $\Phi 1100 \times 600$ mm

安装方式: 搁置式  
 材质: 亚克力  
 颜色: 哑光黑白  
 尺寸:  $\Phi 1100 \times 600$ mm

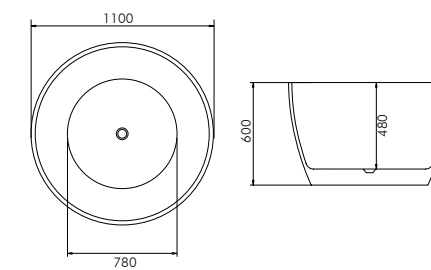



BY-1830

Installation: Freestanding  
 Material: Acrylic  
 Color: Bright white  
 Size: 1700×800×580mm

安装方式: 搁置式  
 材质: 亚克力  
 颜色: 亮光白  
 尺寸: 1700×800×580mm

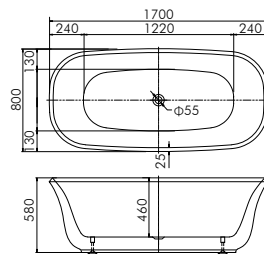

BY-1855

Installation: Built-in  
 Material: Acrylic  
 Color: Matte white  
 Size: 1500×750×460mm  
 : 1700×800×460mm

安装方式: 嵌入式  
 材质: 亚克力  
 颜色: 哑光白  
 尺寸: 1500×750×460mm  
 : 1700×800×460mm

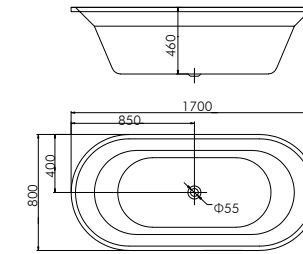



BY-1854

Installation: Built-in  
Material: Acrylic  
Color: Matte white  
Size: 1700×800×450mm

安装方式: 嵌入式  
材质: 亚克力  
颜色: 哑光白  
尺寸: 1700×800×450mm

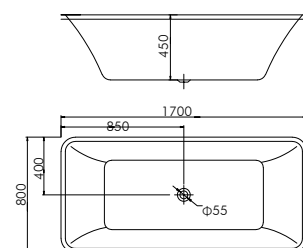

BY-1839

Installation: Built-in  
Material: Acrylic  
Color: Bright white  
Size: 1500×750×450mm  
: 1600×750×450mm  
: 1700×800×450mm  
: 1800×800×450mm

安装方式: 嵌入式  
材质: 亚克力  
颜色: 亮光白  
尺寸: 1500×750×450mm  
: 1600×750×450mm  
: 1700×800×450mm  
: 1800×800×450mm

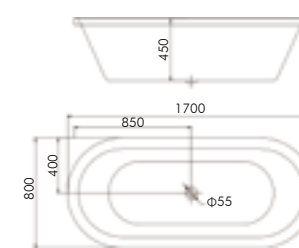





BY-1856

Installation: Built-in  
Material: Acrylic  
Color: Matte white  
Size: 1500×750×450mm  
: 1700×800×450mm

安装方式: 嵌入式  
材质: 亚克力  
颜色: 哑光白  
尺寸: 1500×750×450mm  
: 1700×800×450mm

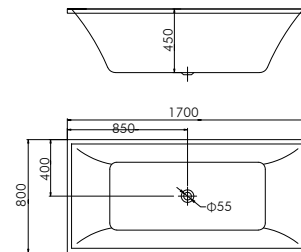

BY-1836

Installation: Built-in  
Material: Acrylic  
Color: Bright white  
Size: 1500×750×480mm  
: 1600×750×480mm  
: 1700×750×480mm

安装方式: 嵌入式  
材质: 亚克力  
颜色: 亮光白  
尺寸: 1500×750×480mm  
: 1600×750×480mm  
: 1700×780×480mm

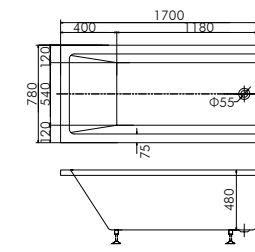

BATHTUB Series 浴缸系列



**BY-1838**

Installation: Built-in  
Material: acrylic  
Color: Bright white  
Size: 2000×1200×540mm

安装方式: 嵌入式  
材质: 亚克力  
颜色: 亮光白  
尺寸: 2000×1200×540mm



**BY-1880**

Installation: Built-in  
Material: Steel plate  
Color: Bright white  
Size: 1700×700×390  
Note: with handrail

安装方式: 搁置式  
材质: 钢板  
颜色: 亮光白  
尺寸: 1700×700×390  
注: 配扶手

BATHTUB Series 浴缸系列



**BY-1842**

Installation: Freestanding  
Material: Cast iron  
Color: Bright white  
Size: 1700×750×537mm

安装方式: 搁置式  
材质: 铸铁  
颜色: 亮光白  
尺寸: 1700×750×537mm



**BY-1846**

Installation: Freestanding  
Material: acrylic  
Color: Matte black and white  
Size: 1600×800×580mm  
: 1700×800×580mm

安装方式: 搁置式  
材质: 亚克力  
颜色: 哑光黑白  
尺寸: 1600×800×580mm  
: 1700×800×580mm

---

# ENGINEERING SYSTEM

工程系统

---

COSO HAS CONSIDERED THE DESIGN AESTHETICS,  
PRACTICAL SCIENCE, EXPERIENTIAL PSYCHOLOGY AND MANY  
OTHER ASPECTS FROM EVERY DETAIL OF THE PRODUCT,  
CREATING THE GREATEST CONVENIENCE AND COMFORT FOR  
YOU. EACH PRODUCT IS LOADED WITH MORE HUMANE CARE.  
ALL THE STARTING POINTS OF OUR PRODUCTS ARE MADE  
FOR THE COMFORT OF LIFE.

# VITALITY

HERE, POWER MEETS  
BEAUTY, VITALITY  
AND PRIMITIVENESS.  
BOLD INNOVATION,  
COLORFUL WORK.



# SCIENCE



ANDHUMAN  
WATER  
SUBJECT AND SPACE

## AUTOFAUCET 感应龙头



GC8035  
Autofaucet  
感应面盆龙头



GC8025  
Autofaucet  
感应面盆龙头



GC8026  
Autofaucet  
感应面盆龙头



GC8036  
Autofaucet  
感应面盆龙头



GC8037  
Autofaucet  
感应面盆龙头



GC8038  
Autofaucet  
感应面盆龙头

## FINGER TOUCHING FAUCET 指控龙头



TC8018  
Finger touching faucet  
指控面盆龙头



TC8022  
Finger touching faucet  
指控面盆龙头



TC8032  
Finger touching faucet  
指控面盆龙头



TC8033  
Finger touching faucet  
指控面盆龙头



BEING UNIQUE IS OUR GOAL, AS CAN BE SEEN  
IN OUR EFFORTS AT PERSONALIZATION.

THE USE IS THE SAME, BUT THE ARTISTIC CONCEPTION IS DIFFERENT, THE SPACE IS THE SAME, BUT THE FEELING IS DIFFERENT.



**DIFFERENT**



URINAL Series 小便器系列



**TC-30300**

Urinal  
Color: white  
Size: 380×395×960mm  
Installation: Floor-standing  
Drainage: Underneath drainage

小便器  
颜色: 白色  
尺寸: 380×395×960mm  
安装方式: 落地式  
排水: 地排式



**TC-30298**

Urinal  
Color: white  
Size: 380×405×1000mm  
Installation: Floor-standing  
Drainage: Underneath drainage

小便器  
颜色: 白色  
尺寸: 380×405×1000mm  
安装方式: 落地式  
排水: 地排式



**TC-30297**

Urinal  
Color: white  
Size: 430×390×960mm  
Installation: Floor-standing  
Drainage: Underneath drainage

小便器  
颜色: 白色  
尺寸: 430×390×960mm  
安装方式: 落地式  
排水: 地排式



**TC-30299**

Urinal  
Color: white  
Size: 360×380×720mm  
Installation: Wall-mounted  
Drainage: Underneath drainage  
Rear drainage

小便器  
颜色: 白色  
尺寸: 360×380×720mm  
安装方式: 挂墙式  
排水: 地排式 / 墙排式



**TC-30296**

Urinal  
Color: white  
Size: 340×320×630mm  
Installation: Wall-mounted  
Drainage: Underneath drainage  
Rear drainage

小便器  
颜色: 白色  
尺寸: 340×320×630mm  
安装方式: 挂墙式  
排水: 地排式 / 墙排式



**TC-30295**

Urinal  
Color: white  
Size: 340×325×580mm  
Installation: Wall-mounted  
Drainage: Underneath drainage  
Rear drainage

小便器  
颜色: 白色  
尺寸: 340×325×580mm  
安装方式: 挂墙式  
排水: 地排式 / 墙排式





## 产品型号分解说明

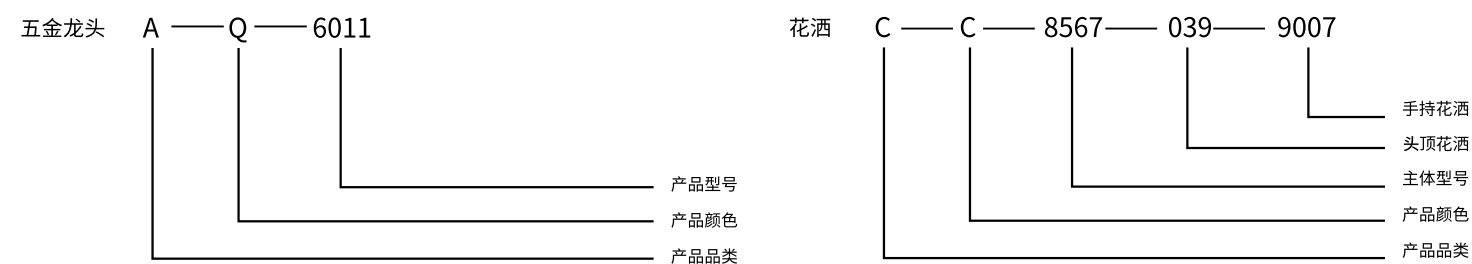

## 颜色注解

字母代码	中文名称	英文名称	字母代码	中文名称	英文名称
C	经典铬	Chrome	F	宝石红	Ruby red
M	雅黑	Elegant black	CG	铬+金	Chrome +Zirconium Gold
G	锆金	Zirconium Gold	B	黑古铜	Bronze black
J	青古铜	Bronze	MG	黑+金	Elegant Black+Zirconium Gold
D	玫瑰金	Rose gold	H	钻石铬	Diamond chromium
E	棕古铜	Brown bronze	MC	黑+铬	Elegant Black+Chrome
Q	枪灰	Gun grey	A	法兰金	Flange gold

## COSO五金分类中英文对照

字母代码	中文名称	英文名称	字母代码	中文名称	英文名称
A	单孔台下盆龙头	Single lever basin faucet	N	缸边浴缸龙头	Bathtub combination
B	单孔台上盆龙头	Single lever basin faucet tall	P	三孔面盆龙头	3-hole basin faucet
C	明装淋浴花洒套装	Revealed shower set	Q	角阀	Angle valves
D	厨房龙头	Kitchen faucet	R	方便龙头	Covenient faucet
E	单孔妇洗盆龙头	Single lever bidet faucet	R	洗衣机龙头	Washing machine faucet
F	暗装面盆龙头	Wall-mounted basin faucet	S	手持花洒	Hand held shower
G	感应面盆龙头	Induction basin faucet	S	头顶花洒	Head shower
H	明装淋浴龙头	Revealed shower mixer	S	体位花洒	Body shower
I	明装浴缸龙头	Revealed bath mixer	S	喷枪	Trigger spray
I	简易淋浴花洒	Shower set	T	指控面盆龙头	Finger touching faucet
K	落地面盆龙头	Floor-standing washbasin faucet	Z	地漏	Floor drain
K	落地浴缸龙头	Floor-standing bathtub faucet	W	五金挂件	Hardware assessories
L	暗装淋浴花洒套装	Concealed shower set	BP	浴室配件	Bathroom accessories
M	分体面盆龙头	Widespread basin mixer	UB	厨房水槽	Kitchen Sink

## 陶瓷型号分解

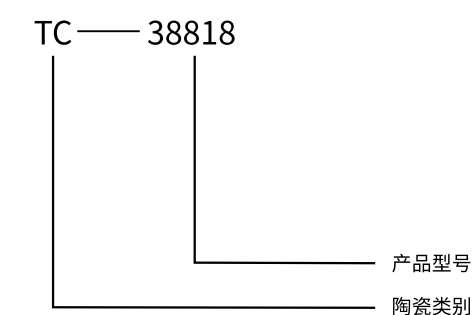

## COSO陶瓷分类中英文对照

字母代码	中文名称	英文名称
TC-388	智能座便器	Intelligent toilet
TC-389	挂式座便器	Hanging wall toilet
TC-386/387	座便器	Toilet
TC-302/303	小便器/蹲便器	Urinal/Squatting pan
TC-306	立柱盆/拖布池	Pedestal washbasin/Mop pool
TC-1	陶瓷配件	Ceramic fitting
BY	浴缸	Bathtub
WT	水箱	Water tank

**COSO**<sup>®</sup>

**@2022 Copyright COSO Technologie Deutschland GmbH**



ZH-2022 The catalogue of **COSO** products is depended on the technological choices and the chromatic aberration that caused by the Table number: 88636488.99/26/3.9. Printed on Deutschland. Printed on the 100% anaerobic bleaching paper.

ZH-2022 德国 **COSO** 高斯产品目录·取决于技术选择和因印刷流程造成的色差  
表格编号 88636488.99/26/3.9. 在德国印制. 印制在 100% 无氯漂白纸张上